

KEYED NOTES	
1	DISHWASHING CEILING IS BEING LOWERED 16 INCHES. LOWER EXISTING SPRINKLER SYSTEM AND INSTALL NEW CONCEALED SPRINKLER HEADS IN DISHWASHING AREA TO MATCH MAIN KITCHEN AREA. CONCEALED SPRINKLER HEADS ARE PERMITTED IN THIS AREA ONLY.
2	NEW DUCTWORK IS BEING INSTALLED AND CONTRACTOR SHALL RELOCATE THE SPRINKLER HEAD IN THE ROOM TO ALLOW DUCTWORK INSTALLATION. CONTRACTOR SHALL PROVIDE SPRINKLER COVERAGE WITHIN THE ROOM PER NFPA 13 CORRESPONDING WITH THE NEW DUCTWORK CONFIGURATION. COORDINATE WORK WITH MECHANICAL CONTRACTOR.
3	THE CEILING IS BEING REMOVED IN ROOM. TURN SPRINKLER HEAD UP AND MOVE HEAD WITHIN 12 INCHES OF THE DECK ABOVE TO PROVIDE PROPER COVERAGE OF THE ROOM.
4	KITCHEN CEILING IS BEING PULLED DOWN TO RUN NEW PLUMBING PIPING FOR NEW FIXTURES ON THIRD FLOOR. ADJUST SPRINKLERS AS NEEDED WHEN CEILING IS RE-INSTALLED.
5	ADJUST SPRINKLER PIPING AND SPRINKLER HEADS AS NECESSARY TO ACCOMMODATE INSTALLATION OF NEW DUCTWORK, STEAM AND CONDENSATE PIPING. COORDINATE WITH MECHANICAL CONTRACTOR.
6	ADJUST SPRINKLER PIPING AND SPRINKLER HEADS AS NECESSARY TO ACCOMMODATE INSTALLATION OF NEW STEAM PIPING AND RE-INSTALLATION OF EXISTING CEILING GRID. COORDINATE WITH MECHANICAL CONTRACTOR.

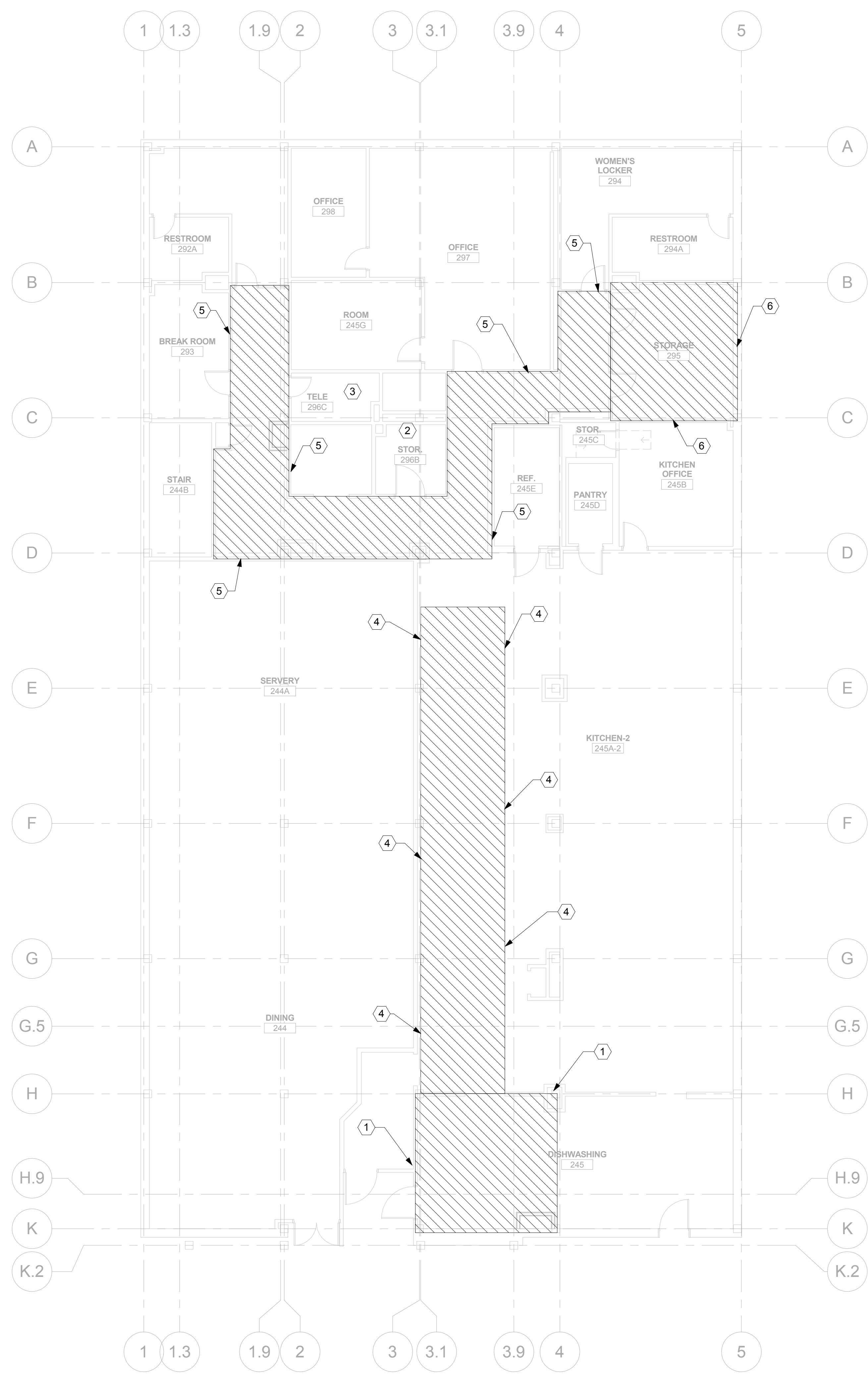

CONTRACTOR TO KEEP FIRE RATINGS IN TACT AT ALL TIMES DURING CONSTRUCTION BY PROVIDING ONE OF THE FOLLOWING SAFETY OPTIONS:

ONE - LEAVE THE EXISTING SPRINKLER SYSTEM OPERATIONAL IN THE RENOVATED AREA AND PROVIDE UPRIGHT SPRINKLER HEADS ON THE EXISTING PIPE TO PROVIDE COVERAGE IN THE AREA OF WORK PER NFPA 13 DURING CONSTRUCTION. THIS WILL LIKELY INVOLVE MOVING SPRINKLERS TO WITHIN 12 INCHES OF THE DECK ABOVE. AFTER THE NEW SPRINKLER PIPING IS INSTALLED, TESTED, AND APPROVED, THE SPRINKLERS AT THE DECK LEVEL AND THE EXISTING PIPING SHALL BE REMOVED.

OR

TWO - CONTRACTOR MAY SHUTDOWN THE EXISTING SPRINKLER SYSTEM IN THE AREA OF WORK PROVIDED THAT THE CONTRACTOR INSTALL A 1-HOUR FIRE-RESISTANCE RATED SEPARATION BETWEEN EVERY OCCUPIED SPACE ADJACENT TO THE CONSTRUCTION AREA. CONTRACTOR SHALL COORDINATE WITH THE VETERANS ADMINISTRATION, THE CONTRACTING OFFICER, AND THE A/E. ALL FIRE-RESISTANCE RATED SEPARATIONS SHALL COMPLY WITH NFPA 101 AND UL LISTINGS.

1 SPRINKLER SECOND FLOOR PLAN
FP102/ 1/8" = 1'-0"

Scale: 1/8" = 1'-0"

0 4 8 16
one eighth inch = one foot

0 4 8 16
one quarter inch = one foot

0 2 4 6 8 10 12 14 16
three eighths inch = one foot

0 2 4 6 8 10 12 14 16
one half inch = one foot

0 2 4 6 8 10 12 14 16
three quarters inch = one foot

0 2 4 6 8 10 12 14 16
one inch = one foot

0 2 4 6 8 10 12 14 16
one and one half inches = one foot

0 2 4 6 8 10 12 14 16
two inches = one foot

0 2 4 6 8 10 12 14 16
three inches = one foot

0 2 4 6 8 10 12 14 16
four inches = one foot

0 2 4 6 8 10 12 14 16
six inches = one foot

0 2 4 6 8 10 12 14 16
one foot = one foot

ENGINEERS/CONSULTANTS:

WOOLPERT, INC.
343 FOUNTAINS PARKWAY
SUITE 100
FAIRVIEW HEIGHTS, IL 62208
314-436-0865
314-436-0884 fax

SCI ENGINEERING, INC
130 POINT WEST BLVD.
ST. CHARLES, MO 63301
636-949-8200
636-949-8269 fax

SEAL

FINAL SUBMITTAL FOR CONSTRUCTION

PROFESSIONAL ENGINEER
STATE OF MISSOURI
NO. 03132017
MELISSA D. WILSON
060-02197
EXP. 11/30/2017

ARCHITECT:

Chiodini
ARCHITECTS

Architecture / Interior Design / Graphics
1401 S. Brentwood Blvd. / Suite 575 / St. Louis, Missouri 63144
314-725-5588 / arch@chiodini.com

THE ARCHITECT EXPRESSLY RESERVES HIS/HER/CHEM/LAW AND STATUTORY AND COPYRIGHTS AND OTHER PROPERTY RIGHTS FOR THESE ARCHITECTURAL, ENGINEERING, TECHNICAL, DOCUMENTS AND ANY DERIVATIVES THEREOF. THESE DRAWINGS AND DOCUMENTS ARE NOT TO BE REPRODUCED, CHANGED OR COPIED IN ANY MANNER WITHOUT THE EXPRESS WRITTEN CONSENT OF CHIODINI ARCHITECTS. FOR ANY USE WITHOUT FIRST OBTAINING THE EXPRESS WRITTEN CONSENT OF CHIODINI ARCHITECTS, THE USER SHALL BE DEEMED TO HAVE WRITTEN PERMISSION AND CONSENT.

© COPYRIGHT PENDING

Drawing Title
SPRINKLER SECOND FLOOR PLAN

Approved: Project Director
Approver

Project Title
VA HEALTH CARE SYSTEM

Project Number
438-16-104 2016.052

Building Number
5

Drawing Number
FP102

Location
VAS 438-16-104 BLDG. 5 CHAPEL
SIOUX FALLS, SD 57105

Date
2017.03.13

Checked
MDM

Drawn
MFB

OWNER

VA

FIRE PROTECTION COVERAGE SCHEDULE

PLAN MARK	OCCUPANCY HAZARD	GROUP	AREA (SQ FT)	AREA (SQ M)	DENSITY (GPM/SQ FT)	DENSITY (LPM/SQ M)	NOTES
A	LIGHT HAZARD	-	225	20.9	.1/1500	.38/139	1,2
B	ORDINARY HAZARD	GROUP 1	130	12.1	.15/1500	.57/139	1,2
C	ORDINARY HAZARD	GROUP 2	130	12.1	.2/1500	.57/139	1,2

NOTES:
 1. PROVIDE QUICK RESPONSE, FACTORY MUTUAL (FM) APPROVED SPRINKLERS, EXCEPT AS NOTED IN SPECIFICATIONS.
 2. CONCEALED SPRINKLERS ARE PROHIBITED EXCEPT AS IDENTIFIED ON THE DRAWINGS FOR THE KITCHEN AREA.

LEGEND:
 SQ FT - SQUARE FEET
 SQ M - SQUARE METERS
 GPM - GALLONS PER MINUTE
 LPM - LITERS PER MINUTE

A - [Pattern]
 B - [Pattern]
 C - [Pattern]

KEYED NOTES

1	INSTALL NEW SPRINKLERS, PIPING AND APPURTENANCES FROM SPRINKLER MAIN TO THE ROOMS. SPRINKLER PIPING SHALL BE ROUTED ABOVE THE CEILING.
2	EXISTING SPRINKLER MAIN IN CORRIDOR TO REMAIN AND BE RE-USED. SPECIFIC LOCATION OF MAIN TO BE CONFIRMED BY SPRINKLER CONTRACTOR AND SHOWN ON THE SHOP DRAWINGS. SPRINKLER CONTRACTOR SHALL ASSESS THE EXISTING HANGING AND BRACING PROVIDED FOR THE EXISTING MAIN AND SHALL PROVIDE ADDITIONAL SUPPORT IF REQUIRED TO COMPLY WITH NFPA 13. SPRINKLER CONTRACTOR TO VERIFY SYSTEM OPERATION WITH EXISTING HYDRAULIC CALCULATIONS FOR BUILDING.
3	EXISTING SPRINKLERS, PIPING AND APPURTENANCES IN ROOMS OUTSIDE OF THE PROJECT AREA SHALL REMAIN. CONTRACTOR SHALL NOT DISTURB OR DISCONNECT THE EXISTING SPRINKLER SYSTEM IN THE AREA NOT IN CONTRACT.

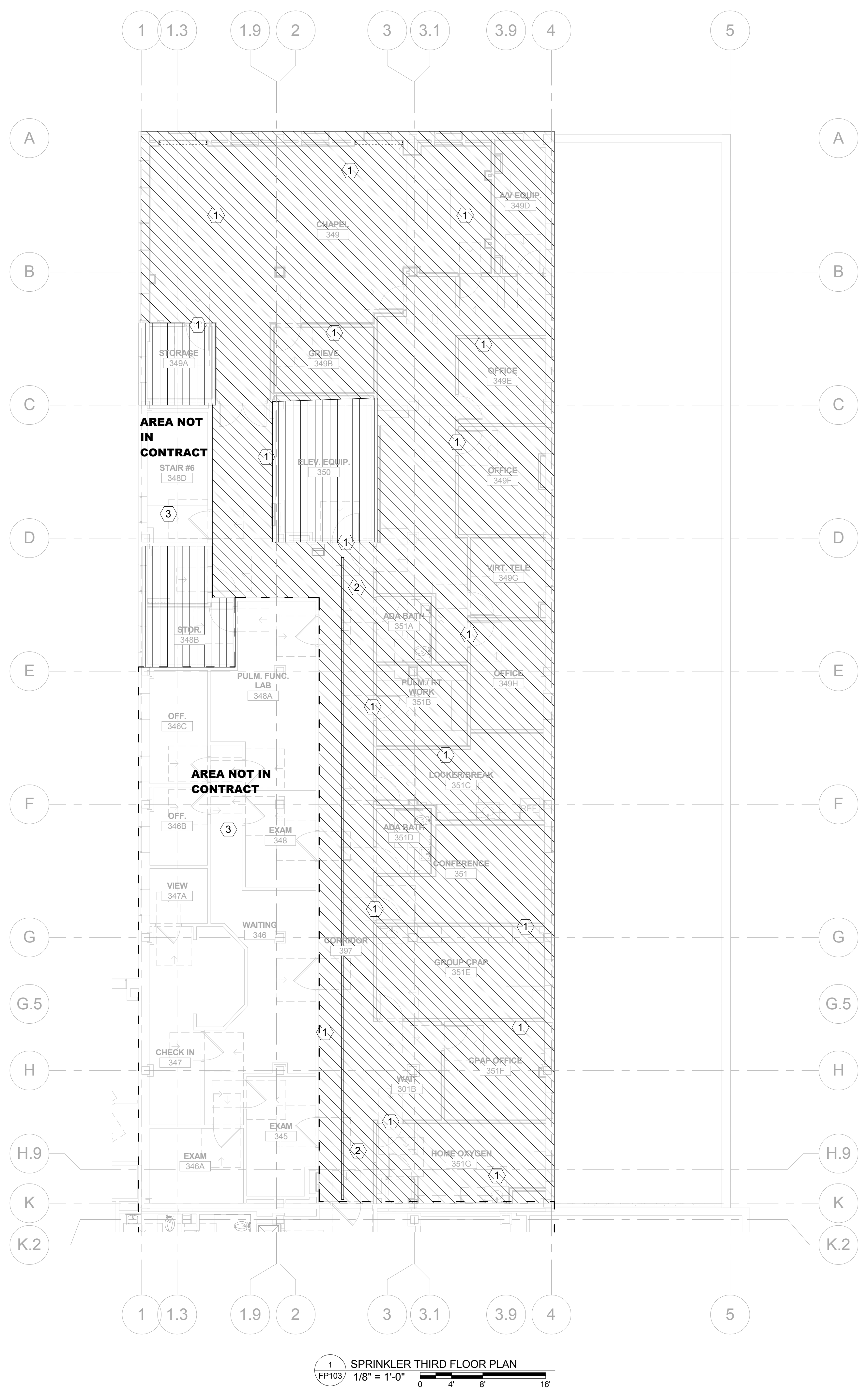

THE SPRINKLER MAIN LOCATED IN THE CORRIDOR IS REQUIRED TO REMAIN ACTIVE DURING BUSINESS HOURS FOR THE DURATION OF THE CONSTRUCTION PERIOD IN ORDER TO SUPPLY THE SPRINKLERS IN THE RESPIRATORY CARE PORTION OF THE FLOOR (NOTED AS OUT OF CONTRACT ON THE PLAN). THE CONTRACTOR IS PERMITTED TO TAKE THE SPRINKLER MAIN TEMPORARILY OUT OF SERVICE AFTER HOURS TO ALLOW THE REMOVAL OF THE DEMOLISHED SPRINKLER BRANCH PIPING AND FOR RE-CONNECTION OF THE NEW SPRINKLER BRANCH PIPING. CONTRACTOR SHALL PROVIDE A FIRE WATCH DURING THE TIME THE SPRINKLER SYSTEM IS TAKEN OUT OF SERVICE. THE TIMING AND DURATION OF THE SPRINKLER SYSTEM SHUTDOWN SHALL BE COORDINATED WITH AND APPROVED BY THE VA AND AUTHORITY HAVING JURISDICTION.

CONTRACTOR TO KEEP FIRE RATINGS IN TACT AT ALL TIMES DURING CONSTRUCTION BY PROVIDING ONE OF THE FOLLOWING SAFETY OPTIONS:
 ONE - LEAVE THE EXISTING SPRINKLER SYSTEM OPERATIONAL IN THE RENOVATED AREA AND PROVIDE UPRIGHT SPRINKLER HEADS ON THE EXISTING PIPE TO PROVIDE COVERAGE IN THE AREA OF WORK PER NFPA 13 DURING CONSTRUCTION. THIS WILL LIKELY INVOLVE MOVING SPRINKLERS TO WITHIN 12 INCHES OF THE DECK ABOVE. AFTER THE NEW SPRINKLER PIPING IS INSTALLED, TESTED, AND APPROVED, THE SPRINKLERS AT THE DECK LEVEL AND THE EXISTING PIPING SHALL BE REMOVED.
 OR
 TWO - CONTRACTOR MAY SHUTDOWN THE EXISTING SPRINKLER SYSTEM IN THE AREA OF WORK PROVIDED THAT THE CONTRACTOR INSTALL A 1-HOUR FIRE-RESISTANCE RATED SEPARATION BETWEEN EVERY OCCUPIED SPACE ADJACENT TO THE CONSTRUCTION AREA. CONTRACTOR SHALL COORDINATE WITH THE VETERANS ADMINISTRATION, THE CONTRACTING OFFICER, AND THE A/E. ALL FIRE-RESISTANCE RATED SEPARATIONS SHALL COMPLY WITH NFPA 101 AND U.L. LISTINGS.

1 SPRINKLER THIRD FLOOR PLAN
 FP103 1/8" = 1'-0"

three eighths inch = one foot
 one eighth inch = one foot
 one quarter inch = one foot
 one half inch = one foot
 one inch = one foot
 three quarters inch = one foot
 two inches = one foot
 three inches = one foot
 four inches = one foot
 five inches = one foot
 six inches = one foot
 eight inches = one foot
 ten inches = one foot
 twelve inches = one foot
 fifteen inches = one foot
 twenty inches = one foot
 twenty five inches = one foot
 thirty inches = one foot
 thirty six inches = one foot
 forty inches = one foot
 forty five inches = one foot
 fifty inches = one foot
 fifty six inches = one foot
 sixty inches = one foot
 sixty six inches = one foot
 seventy inches = one foot
 seventy six inches = one foot
 eighty inches = one foot
 eighty six inches = one foot
 ninety inches = one foot
 ninety six inches = one foot
 one hundred inches = one foot

Scale: As indicated

ENGINEERS/CONSULTANTS:
 WOOLPERT, INC.
 343 FOUNTAINS PARKWAY
 SUITE 100
 FAIRVIEW HEIGHTS, IL 62208
 314-436-0865
 314-436-0884 fax

SCI ENGINEERING, INC
 130 POINT WEST BLVD.
 ST. CHARLES, MO 63301
 636-949-8200
 636-949-8269 fax

FINAL SUBMITTAL FOR CONSTRUCTION

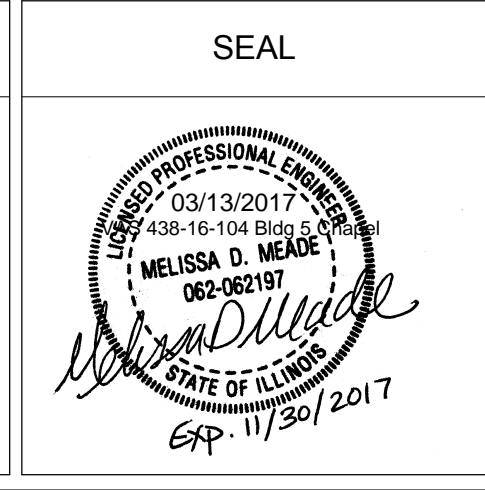

ARCHITECT:
Chiodini ARCHITECTS
 Architecture / Interior Design / Graphics
 1401 S. Brentwood Blvd. / Suite 575 / St. Louis, Missouri 63144
 314-725-5588 / arch@chiodini.com

THE ARCHITECT EXPRESSLY RESERVES HIS COMMON LAW AND STATUTORY LAW COPYRIGHTS AND OTHER PROPERTY RIGHTS IN THESE ARCHITECTURAL WORKS AND TECHNICAL DRAWINGS AND ANY DERIVATIVES THEREOF. THESE DRAWINGS AND DOCUMENTS ARE NOT TO BE REPRODUCED, CHANGED OR COPIED IN ANY MANNER WITHOUT THE EXPRESS WRITTEN CONSENT OF CHIODINI ARCHITECTS. THESE RIGHTS ARE NOT TO BE ASSIGNED TO ANY PARTY WITHOUT FIRST OBTAINING THE WRITTEN PERMISSION AND CONSENT OF CHIODINI ARCHITECTS.
 © COPYRIGHT PENDING

Drawing Title
SPRINKLER THIRD FLOOR PLAN

Approved: Project Director
 Approver

Project Title
VA HEALTH CARE SYSTEM

Location
 VAS 438-16-104 BLDG. 5 CHAPEL
 SIOUX FALLS, SD 57105

Date
 2017.03.13

Checked
 MDM

Drawn
 MFB

Project Number
 438-16-104 2016.052

Building Number
 5

Drawing Number
FP103

