

TS  
f  
ion  
ies  
ent  
ent of  
Affairs



Department of  
Veterans Affairs



three inches = one foot  
one and one half inches = one foot  
one inch = one foot  
three quarters inch = one foot  
one half inch = one foot  
three eighths inch = one foot  
one quarter inch = one foot  
one eighth inch = one foot

OWNER'S REPRESENTATIVE

THROUGHOUT THESE GENERAL NOTES THE CONTRACTING OFFICER IS NAMED AS THE OWNER'S REPRESENTATIVE WITH REGARD TO CONTRACTUAL ITEMS. THE CONTRACTING OFFICER INCLUDES THE CONTRACTING OFFICER'S REPRESENTATIVE (COR), IF THEY ARE RESPONSIBLE FOR THAT ROLE. PLEASE CONTACT THE OMAHA VA FOR CONFIRMATION ON THE ROLES AND RESPONSIBILITIES OF THE CONTRACTING OFFICER AND THE CONTRACTING OFFICER'S REPRESENTATIVE (COR).

PROJECT INTENT

THE EXPECTED CIVIL REQUIREMENTS FOR THIS PROJECT INCLUDE THE FOLLOWING:

1. INSTALLATION OF TEMPORARY CONSTRUCTION FENCE AROUND CONTRACTOR'S STAGING, STORAGE AND WORK AREA.
2. REMOVAL AND REPLACEMENT OF THE EXISTING SURFACE IMPROVEMENTS INCLUDING ASPHALT SURFACING, CONCRETE SURFACING AND LANDSCAPING.
3. INSTALLATION OF TRAFFIC CONTROL.
4. INSTALLATION OF THE NEW SANITARY SEWER MAIN AND SERVICE, INCLUDING BEDDING, BACKFILL AND TESTING.
5. INSTALLATION OF ELECTRICAL DUCT BANK.
6. CONNECTION TO MANHOLE AND INSTALLATION OF INSIDE DROP.
7. TRAFFIC CONTROL AROUND THE CONTRACTOR'S STAGING, STORAGE AND WORK AND AREA AND THE SANITARY SEWER WORK.

TOPOGRAPHIC SURVEY

THIS TOPOGRAPHIC SURVEY WAS PROVIDED BY CNC SURVEYING, LLC. THIS SURVEY WAS CONDUCTED IN OCTOBER 2020. CHANGES IN UTILITIES AND OTHER SITE FEATURES SINCE THE SURVEY MAY HAVE OCCURRED.

CONSTRUCTION SURVEY STAKING

THE CONTRACTOR IS RESPONSIBLE FOR CONSTRUCTION STAKING AND SHOULD PROTECT ALL CONSTRUCTION STAKES. THE CONTRACTOR SHALL PROVIDE A NEBRASKA REGISTERED LAND SURVEYOR TO OVERSEE THE STAKING OF THE PROPOSED IMPROVEMENTS.

UTILITIES

THE INFORMATION ON THESE PLANS CONCERNING THE TYPE, SIZE AND LOCATION OF UTILITIES HAS BEEN SHOWN BASED UPON THE BEST INFORMATION AVAILABLE. THE UTILITY LOCATIONS SHOWN WERE BASED ON FIELD LOCATES PROVIDED BY PRIVATE UTILITIES BASED ON THE SURVEYOR'S REQUEST THROUGH ONE CALL AND FROM THE OMAHA VA'S RECORDS. THE EXACT SIZE AND LOCATION OF UNDERGROUND UTILITIES WAS NOT VERIFIED BY EXCAVATION. THE CONTRACTOR IS RESPONSIBLE FOR DETERMINING THE EXACT LOCATION OF ALL UTILITIES PRIOR TO BEGINNING CONSTRUCTION INCLUDING DEPTH OF BURY. THE CONTRACTOR SHALL FIELD VERIFY THE SIZE AND TYPE OF ALL PIPES, CULVERTS, CONDUITS, ETC. THAT ARE BEING REPLACED, CROSSED OR CONNECTED PRIOR TO ORDERING ANY NEW MATERIAL. THE CONTRACTOR IS RESPONSIBLE FOR PROTECTING ALL EXISTING UTILITIES IN PLACE. CONTRACTOR SHALL COORDINATE ALL RELOCATIONS WITH THE UTILITY COMPANIES AND THE CONTRACTING OFFICER'S REPRESENTATIVE (COR).

IF ANY OTHER UTILITES ARE ENCOUNTERED BUT NOT SHOWN ON THE SITE PLAN CONTACT THE OWNER AND UTILITY COMPANY IMMEDIATELY.

- THE CONTRACTOR SHALL PROVIDE A DETAILED UTILITY PHASING PLAN 10 DAYS PRIOR TO STARTING UTILITY WORK THAT INCLUDES THE FOLLOWING:
1. SCHEDULE OF DEMOLITION AND UTILITY REMOVAL AND ABANDONMENT
  2. WHAT UTILITIES WILL REQUIRE TEMPORARY OUTAGES AND APPROXIMATE DURATION
  3. HOW THE CONTRACTOR WILL PROVIDE TEMPORARY SERVICE FOR ALL UTILITIES
  4. PHASING AND CONSTRUCTION METHODS BEING PROPOSED TO MINIMIZE THE DISRUPTION TO THE UTILITY SYSTEM

THE CONTRACTOR SHALL GIVE THE CONTRACTING OFFICER NOTICE FOR UTILITY OUTAGES IN ACCORDANCE WITH THE FOLLOWING:

DURATION OF OUTAGE	SUBMIT REQUEST IN ADVANCE OF OUTAGE
<2 HOURS	3 DAYS (72 HOURS)
2-24 HOURS	7 DAYS
>24 HOURS	10 DAYS

THE CONTRACTOR SHALL RECEIVE PERMISSION FROM THE CONTRACTING OFFICER PRIOR TO THE SHUTDOWN OF ANY PORTION OF THE UTILITY SYSTEMS. THE CONTRACTOR SHALL MAKE A CONCERTED EFFORT TO RESTORE UTILITY SERVICES AS SOON AS POSSIBLE AFTER SHUTDOWN. THE CONTRACTING OFFICER SHALL HAVE THE RIGHT TO REFUSE THE CONTRACTOR'S REQUEST TO SHUTDOWN ANY PORTION OF THE DISTRIBUTION SYSTEM IF THE CONTRACTING OFFICER DETERMINES THERE ARE CIRCUMSTANCES THAT PROHIBIT THE SHUTDOWN AT THE PARTICULAR TIME REQUESTED. THE CONTRACTOR SHALL BE RESPONSIBLE FOR CONTACTING THE CONTRACTING OFFICER ONCE THE SYSTEM OR SERVICE HAS BEEN RESTORED.

THE OMAHA VA CAMPUS IS A 24-HOUR FACILITY AND SHUT-DOWNS OF SERVICES NEED TO BE MINIMIZED AS MUCH AS POSSIBLE AND COORDINATED THROUGH THE COR.

ADJUSTMENT OF UTILITIES

ALL MANHOLE CASTINGS AND VALVE BOXES WITHIN THE CONSTRUCTION LIMITS SHALL BE ADJUSTED TO FINAL GRADE.

EXPLORATORY EXCAVATION

THE ELEVATION OF EXISTING UTILITIES IS APPROXIMATE AND BASED ON STANDARD UTILITY BURIAL DEPTHS AND MUST BE VERIFIED BY THE CONTRACTOR. ALL EXISTING UTILITIES THAT CROSS THE PROPOSED UTILITIES MUST BE VERTICALLY AND HORIZONTALLY LOCATED UTILIZING NON-DESTRUCTIVE EXPLORATORY METHODS, SUCH AS EXPLORATORY EXCAVATION, VACUUM EXCAVATION OR GROUND PENETRATING RADAR. THE CONTRACTOR WILL BE RESPONSIBLE FOR ALL COSTS RELATED TO A UTILITY THAT IS SHOWN ON THE PLANS AND NOT INVESTIGATED. ANY CHANGES TO THE PROFILE NECESSARY TO AVOID EXISTING UTILITIES MUST BE APPROVED BY THE COR. IF THE CHANGE REQUIRES ADDITIONAL PAYMENT IT MUST BE APPROVED BY THE CONTRACTING OFFICER.

EXISTING UTILITY CROSSINGS

AT ALL LOCATIONS WHERE THE PROPOSED UTILITY IMPROVEMENT CROSSES OR IS ADJACENT TO EXISTING UTILITIES THE CONTRACTOR SHALL BE RESPONSIBLE FOR SAFEGUARDING THE EXISTING UTILITY TO ENSURE THAT THEY ARE NOT DISTURBED DURING THE WORK. TEMPORARY STRUCTURAL SUPPORT FOR THE UTILITIES MAY BE REQUIRED. ANY REPAIR WORK NECESSARY TO A CROSSED UTILITY RESULTING FROM THE CONTRACTOR'S ACTIVITY SHALL BE AT THE CONTRACTOR'S EXPENSE.

THE CONTRACTOR SHALL MAINTAIN EXISTING UTILITIES AND PROTECT THEM AGAINST DAMAGE DURING DEMOLITION OPERATIONS. ANY DISRUPTION IN SERVICE SHALL BE COORDINATED WITH THE CONTRACTING OFFICER. THE CONTRACTOR SHALL PROVIDE A METHOD OF TEMPORARY SERVICE DURING PERIODS OF DISRUPTION.

THE CONTRACTOR MAY USE CONTROLLED LOW STRENGTH BACKFILL MATERIAL TO SUPPORT THE UTILITIES WITH THE CONTRACTING OFFICER'S APPROVAL.

DEMOLITION AND ABANDONMENT

IT IS THE CONTRACTOR'S RESPONSIBILITY TO FIELD INSPECT AND VERIFY THE PROJECT LIMITS PRIOR TO BIDDING TO DETERMINE, SIZE, NUMBER AND LIMITS OF VISIBLE OBSTRUCTIONS WHICH ARE TO BE REMOVED, RELOCATED OR SALVAGED INCLUDING TREES, UTILITIES, ETC.

DO NOT DISTURB ANY TREES OR STRUCTURES NOT DESIGNATED TO BE REMOVED. ANY UTILITIES TO BE ABANDONED IN PLACE AS SHOWN ON THE PLANS SHALL BE CONFIRMED BY THE CONTRACTING OFFICER PRIOR TO ABANDONMENT.

REMOVALS

REMOVAL AND SALVAGE OF ITEMS SHALL BE IN ACCORDANCE WITH THE SPECIFICATIONS. REMOVALS LIMITS SHOWN ON THE CIVIL PLANS ARE APPROXIMATE AND WILL NEED TO BE FIELD VERIFIED BY THE CONTRACTOR.

ALL CONCRETE AND ASPHALT REMOVAL ITEMS SHALL BE SAW-CUT PRIOR TO REMOVAL, THEN RECUT PRIOR TO ASPHALT PAVEMENT PATCH. USE CARE IN DEMOLITION OPERATIONS ADJACENT TO BUILDINGS AND WHEN CONNECTING TO EXISTING BUILDINGS.

PAVEMENT REMOVAL

AREAS OF PAVEMENT REMOVAL SHALL BE AS SHOWN ON THE PLANS OR AS DIRECTED BY THE CONTRACTING OFFICER. ALL PAVEMENT AND AGGREGATE BASE COURSE REMOVED SHALL BE DISPOSED OF OFF-SITE.

WHEN NEW PAVEMENT IS PLACED ADJACENT TO EXISTING SURFACING, THE MATCH LINE SHALL BE CUT OR SAWED IN THE EXISTING SURFACE TO OBTAIN A VERTICAL, STRAIGHT EDGE.

EQUIPMENT, MATERIALS AND STAGING AREA

A LOCATION FOR AN EQUIPMENT, MATERIALS STORAGE AND STAGING AREA IS SHOWN ON THE PLANS. THE CONTRACTOR IS RESPONSIBLE FOR THE SECURITY AND PROTECTION OF ALL STORED EQUIPMENT AND MATERIALS. TEMPORARY CHAIN-LINK CONSTRUCTION FENCING FOR THIS AREA IS REQUIRED. THE FENCE SHALL INCLUDE OPAQUE FABRIC SCREENING (>98% OPAQUE). THE CONTRACTOR SHALL ALSO RECLAIM THIS AREA AT THE CONCLUSION OF THE PROJECT.

TRAFFIC CONTROL

THE CONTRACTOR IS RESPONSIBLE FOR COORDINATING ALL DETOURS AND TRAFFIC CONTROL MEASURES, AND MAINTAINING TWO-WAY TRAFFIC UNLESS APPROVED OTHERWISE BY THE CONTRACTING OFFICER. TRAFFIC CONTROL SHALL BE IN ACCORDANCE WITH THE CURRENT VERSION OF THE MANUAL ON UNIFORM TRAFFIC CONTROL DEVICES (MUTCD) AND SHEET CT-100.

DIFFERING SITE CONDITIONS

IF CONTAMINATED SOILS OR ANY UNUSUAL BURIED DEBRIS ARE ENCOUNTERED DURING EXCAVATION, CONTRACTOR SHALL CEASE WORK AND CONTACT THE CONTRACTING OFFICER.

CONTRACTOR SHALL NOTIFY THE CONTRACTING OFFICER, IF UNSTABLE MATERIAL OR GROUND WATER IS ENCOUNTERED IN AN EXCAVATION/TRENCH BOTTOM WHICH WILL REQUIRE THE CONSTRUCTION TECHNIQUES IN SECTION 31 20 11 EARTH MOVING TO BE MODIFIED. AFTER SUCH NOTIFICATION, CONTRACTOR SHALL AWAIT DIRECTION FROM THE CONTRACTING OFFICER ON ACCEPTABLE CONSTRUCTION TECHNIQUES, PRIOR TO RESUMING WORK.

CONSTRUCTION LIMITS

IN GENERAL, THE CONSTRUCTION LIMITS FOR THIS PROJECT ARE SHOWN ON THE PLANS AND SHALL BE DEFINED AS FOLLOWS:

1. CONSTRUCTION ACTIVITIES SHALL BE LIMITED TO THE CONSTRUCTION LIMITS SHOWN ON THE PLANS UNLESS PRIOR APPROVAL IS RECEIVED FROM THE CONTRACTING OFFICER. USE OF OTHER PROPERTY ON THE CAMPUS OTHER THAN THOSE DESIGNATED FOR STAGING AREAS, MATERIAL STORAGE, DEWATERING, AND/OR TOPSOIL STOCKPILING WILL NOT BE ALLOWED. ANY DAMAGES AND RESTORATION OUTSIDE OF THE CONSTRUCTION LIMITS SHALL BE AT THE CONTRACTOR'S EXPENSE.
2. THE CONTRACTOR SHALL TAKE CARE TO PROTECT EXISTING IMPROVEMENTS. ALL EXISTING IMPROVEMENTS DISTURBED WITHIN THE CAMPUS WHETHER NOTED ON THESE PLANS OR NOT, SHALL BE REPLACED IN KIND. ANY COSTS FOR SUCH REPLACEMENT SHALL BE CONSIDERED INCIDENTAL TO THIS PROJECT.

WATER FOR CONSTRUCTION

THE CONTRACTOR SHALL BE RESPONSIBLE FOR PROVIDING WATER FOR COMPACTION OF SCARIFIED MATERIAL, FILL GRANULAR MATERIALS AND TRENCH BACKFILL AS REQUIRED. THE VA WILL SUPPLY WATER FOR COMPACTION AND DUST CONTROL AT NO CHARGE. THE CONTRACTOR MAY CONNECT TO HYDRANTS WITH THE APPROVAL OF THE CONTRACTING OFFICER. THE CONTRACTOR MUST SUPPLY A DOUBLE CHECK VALVE. THE COSTS FOR LOADING, TRANSPORTING AND APPLYING WATER SHALL BE THE RESPONSIBILITY OF THE CONTRACTOR. COORDINATE WITH THE COR FOR WATER ACCESS ON EACH PHASE OF THE PROJECT.

CONSTRUCTION FENCING

THE CONTRACTOR SHALL INSTALL A CONSTRUCTION FENCE AROUND ANY OPEN TRENCHES AT THE END OF THE DAY AND ANYTIME THE TRENCH IS LEFT UNATTENDED TO PROVIDE PUBLIC SAFETY. THE CONSTRUCTION FENCE SHALL BE A MINIMUM 4' HIGH ORANGE "SAFETY FENCE" ATTACHED TO METAL POSTS OR OTHER APPROVED FENCING.

GRADING OPERATIONS

THE CONTRACTOR WILL BE REQUIRED TO RAZE, REMOVE AND DISPOSE OF ALL HARDSCAPE AND OTHER OBSTRUCTIONS OF WHICH ANY PORTION ARE IN THE CONSTRUCTION LIMITS IN ACCORDANCE WITH THE SPECIFICATIONS AND PLANS. THE CONTRACTOR SHALL BE RESPONSIBLE TO DISPOSE OF ALL HARDSCAPE, ROCKS, RUBBLE, AND EXCESS SOIL OFF SITE. SEED IN COMPLIANCE WITH EROSION CONTROL PLAN REQUIREMENTS. COORDINATE EXACT LOCATION WITH THE CONTRACTING OFFICER. ALL TRANSPORTATION, LOADING AND UNLOADING AND TEMPORARY DRAINAGE DURING CONSTRUCTION IS THE CONTRACTOR'S RESPONSIBILITY.

THE CONTRACTOR SHALL BE AWARE OF EXISTING DRAINAGE CONDITIONS AND FACILITIES, AND SHALL PROVIDE FOR DRAINAGE AND EROSION CONTROL DURING ALL PHASES OF CONSTRUCTION. DAMAGE CAUSED BY IMPROPER TEMPORARY DRAINAGE FACILITIES SHALL BE REPAIRED AT THE CONTRACTOR'S EXPENSE TO THE SATISFACTION OF THE CONTRACTING OFFICER.

SALVAGE AND PLACE TOPSOIL

TOPSOIL WITHIN THE CONSTRUCTION LIMITS SHALL BE STRIPPED AND STOCKPILED TEMPORARILY WITHIN THE PROJECT LIMITS AS APPROVED BY THE COR. ALL EXCESS TOPSOIL SHALL BE REMOVED FROM THE MEDICAL CENTER PROPERTY AND DISPOSED OF OFF-SITE BY THE CONTACTOR. PLACE SOD IN COMPLIANCE WITH EROSION CONTROL PLAN REQUIREMENTS. COORDINATE EXACT LOCATION WITH THE CONTRACTING OFFICER. ALL TRANSPORTATION, LOADING AND UNLOADING AND TEMPORARY DRAINAGE DURING CONSTRUCTION IS THE CONTRACTOR'S RESPONSIBILITY.

FOLLOWING COMPLETION OF GRADING OPERATIONS, THE SALVAGED TOPSOIL SHALL BE SPREAD EVENLY AT FOUR (4) INCHES FINISHED DEPTH OVER THE DISTURBED AREAS WITHIN THE WORK LIMITS AND PREPARED FOR SOD IN ACCORDANCE WITH THE SPECIFICATIONS. RESTORATION OF DISTURBED AREAS CREATED DURING CONSTRUCTION OUTSIDE OF THE CONSTRUCTION LIMITS SHALL BE THE RESPONSIBILITY OF THE CONTRACTOR.

THE CONTRACTOR IS REQUIRED TO PROVIDE AND PLACE ANY ADDITIONAL TOPSOIL NECESSARY TO PROVIDE THE 4" REQUIRED DEPTH AT NO ADDITIONAL COST TO THE OWNER.

TRENCHING AND SHORING

THE CONTRACTOR SHALL BE RESPONSIBLE TO INSURE THAT ALL EXCAVATION, TRENCHING AND SHORING, AND THE LIKE SHALL BE PERFORMED IN A MANNER THAT COMPLIES WITH OSHA, DEPARTMENT OF LABOR, AND SAFETY AND HEALTH REGULATIONS FOR CONSTRUCTION AND STANDARD SPECIFICATIONS.

WATER / SEWER ENCASEMENT

WHERE INDICATED ON PLANS OR REQUIRED BY THE PROJECT SPECIFICATIONS PIPE SHALL BE ENCASED WITH CONTROLLED LOW STRENGTH MATERIAL (FLOWABLE FILL). ENCASEMENT SHALL COMPLETELY SURROUND THE PIPE SO AS TO FULLY ENCASE THE PIPE AND SHALL BE CONSTRUCTED AS SHOWN IN THE DETAILS.

SITE CLEAN-UP

ALL PAVED ROADS ADJACENT TO PROJECT AREAS SHALL BE CLEANED OF CONSTRUCTION DEBRIS AT THE END OF EACH DAY OR MORE FREQUENTLY IF NEEDED. SEDIMENT AND MILLINGS SHALL BE REMOVED FROM ROADS BY SHOVELING OR SWEEPING AND BE TRANSPORTED TO A CONTROLLED SEDIMENT DISPOSAL AREA.

AS-BUILTS

THE CONTRACTOR SHALL MEASURE AND RECORD ANY HORIZONTAL OR VERTICAL DEVIATIONS FROM THE CONTRACT DRAWINGS. THE CHANGES SHALL BE RECORDED IN AN ACCURATE, NEAT FASHION ON FULL SCALE DRAWINGS AND FURNISHED TO THE CONTRACTING OFFICER WITHIN 14 DAYS OF COMPLETION OF THE PROJECT. SPECIFICALLY, ALL SERVICE TAPS, CONNECTIONS, AND BURIED FITTINGS SHALL BE RECORDED FOR THE WORK. THE AS-BUILT DRAWINGS SHALL BE ON-SITE AND AVAILABLE FOR REVIEW BY THE ENGINEER OR CONTRACTING OFFICER UPON REQUEST.

IRRIGATION

MAPPING OF THE IRRIGATION SYSTEM WAS NOT AVAILABLE. IT IS THE CONTRACTOR'S RESPONSIBILITY TO INSPECT THE WORK AREA PRIOR TO BEGINNING EXCAVATION TO IDENTIFY IRRIGATION MAINS, HEADS, LATERALS AND APPURTENANCES.. THE CONTRACTOR IS ALSO RESPONSIBLE FOR AVOIDING DAMAGE TO THE IRRIGATION SYSTEM AS IS PRACTICAL. IF THE IRRIGATION SYSTEM IS DAMAGED, IT SHALL BE TEMPORARILY REPAIRED WITHIN 24 HOURS. FINAL REPAIRS SHALL BE PERFORMED WITH LIKE MATERIALS APPROVED BY THE COR. IRRIGATION TO BE REPLACED IN SAME CONDITION AS EXISTING.

PAVEMENT STRIPING

CONTRACTOR SHALL TAKE MEASUREMENTS OF ALL PAVEMENT STRIPING PRIOR TO DEMOLITION AND REMOVAL. THE CONTRACTOR SHALL REPLACE PAVEMENT STRIPING TO MATCH THE ORIGINAL IN ACCORDANCE WITH THE SPECIFICATIONS.

PEDESTRIAN TRAFFIC

SIGNIFICANT PEDESTRIAN TRAFFIC NAVIGATES BACK AND FORTH FROM THE PARKING LOTS IN THE AREA. THESE CORRIDORS SHALL BE MAINTAINED ACCESSIBLE THROUGHOUT THE PROJECT, BUT MAY BE CLOSED TEMPORARILY IF REQUIRED AS PROJECT PHASING REQUIRES. THE CLOSURE OF THIS PEDESTRIAN CORRIDOR WILL REQUIRE A MINIMUM OF 7 DAYS NOTICE AND THE APPROVAL OF A PEDESTRIAN TRAFFIC CONTROL PLAN THAT ADDRESSES THE SAFETY OF THE PEDESTRIAN AND PROVIDES ADEQUATE SIGNAGE FOR THE DETOUR ROUTE.

PROTECTION OF PEDESTRIAN TRAFFIC FROM OPEN EXCAVATIONS AND OTHER HAZARDS IN AND AROUND THE CONSTRUCTION SITE SHALL BE IN COMPLIANCE WITH OSHA, THE AMERICANS WITH DISABILITIES ACT, AND AS DIRECTED BY THE COR.

BYPASS PUMPING AND TESTING OF SANITARY SEWER

BYPASS PUMPING AND TESTING OF THE PROPOSED SANITARY SEWER MAIN AND MANHOLES SHALL BE COMPLETED ACCORDING TO THE CITY OF OMAHA STANDARD SPECIFICATIONS. ALL SANITARY SEWER MAINS AND MANHOLES WILL BE REQUIRED TO BE TESTED AND APPROVED PER SPECIFICATIONS PRIOR TO BEING PUT IN SERVICE.

PRIOR TO PERFORMING THE WORK, THE CONTRACTOR SHALL SUBMIT A PLAN TO THE COR DETAILING THE CONTRACTOR'S PROPOSAL FOR MAINTAINING SEWER SERVICE DURING CONSTRUCTION. THE PLAN SHALL CONTAIN THE CONTRACTOR'S PROPOSED PROCEDURES FOR BYPASS PUMPING (IF REQUIRED), FLOW DIVERSION, AND TESTING FOR EACH PHASE OF THE CONTRACTOR'S SANITARY SEWER CONSTRUCTION SCHEDULE. THE PLAN SHALL ALSO INCLUDE PROPOSED FITTING TYPE(S) AND SHALL INDICATE IF THE FITTING WILL REMAIN IN THE SYSTEM OR WILL BE REMOVED AT THE END OF CONSTRUCTION. 4" AND 6" TEES WILL BE ALLOWED TO REMAIN IN THE SYSTEM IF THEY ARE ROTATED TO THE VERTICAL POSITION AND CAPPED. ALL OTHER FITTINGS NOT SHOWN ON THE PLANS OR PREVIOUSLY APPROVED BY THE COR SHALL BE CONSIDERED TEMPORARY AND MUST BE REMOVED AT THE END OF CONSTRUCTION. THE CONTRACTOR SHALL NOT PROCEED WITH INSTALLATION OF SANITARY SEWER UNTIL THIS PLAN IS APPROVED BY THE COR.

CONTRACTOR SHALL PROVIDE ALL EQUIPMENT, LABOR AND MATERIALS REQUIRED TO MAINTAIN SEWER SERVICE THROUGHOUT THE PROJECT.

CONSTRUCTION DOCUMENTS

		CONSULTANTS:		ARCHITECT		Drawing Title		Project Title		Project Number		Office of Construction and Facilities Management	
		TERRASITE DESIGN 1635 DEADWOOD AVENUE RAPID CITY, SOUTH DAKOTA 57702 PH: (605) 791-1736		ALBERTSON ENGINEERING, INC. 315 NORTH MAIN AVENUE, SUITE 200 SIOUX FALLS, SOUTH DAKOTA 57104 PH: (605) 274-0880		SITE GENERAL NOTES		Design/Construct Sterile Processing Service- Omaha VA Medical Center		16.2330.A08			
		FARRIS ENGINEERING 12700 WEST DODGE ROAD OMAHA, NEBRASKA 68154 PH: (402) 330-5900		FOURFRONT DESIGN, INC. 517 7TH STREET RAPID CITY, SOUTH DAKOTA 57701 PH: (605) 342-9470 FAX: (605) 342-2377 WWW.FOURFRONTDESIGN.COM		Approved: Project Director Omaha VA Medical Center		Location 4101 Woolworth Ave #4199 Omaha, Ne 68105		Building Number 25		Drawing Number C-100	
COMPLIANCY REVIEW INCLUDED		2/23/2024		16.2330.A08				Date 11/23/2020		Checked SM			
Revisions:		Date										Dwg. 11 of 193	



8/2/2020 11:42:26 AM

three inches = one foot  
one and one half inches = one foot  
one inch = one foot  
three quarters inch = one foot  
one half inch = one foot  
three eighths inch = one foot  
one quarter inch = one foot  
one eighth inch = one foot

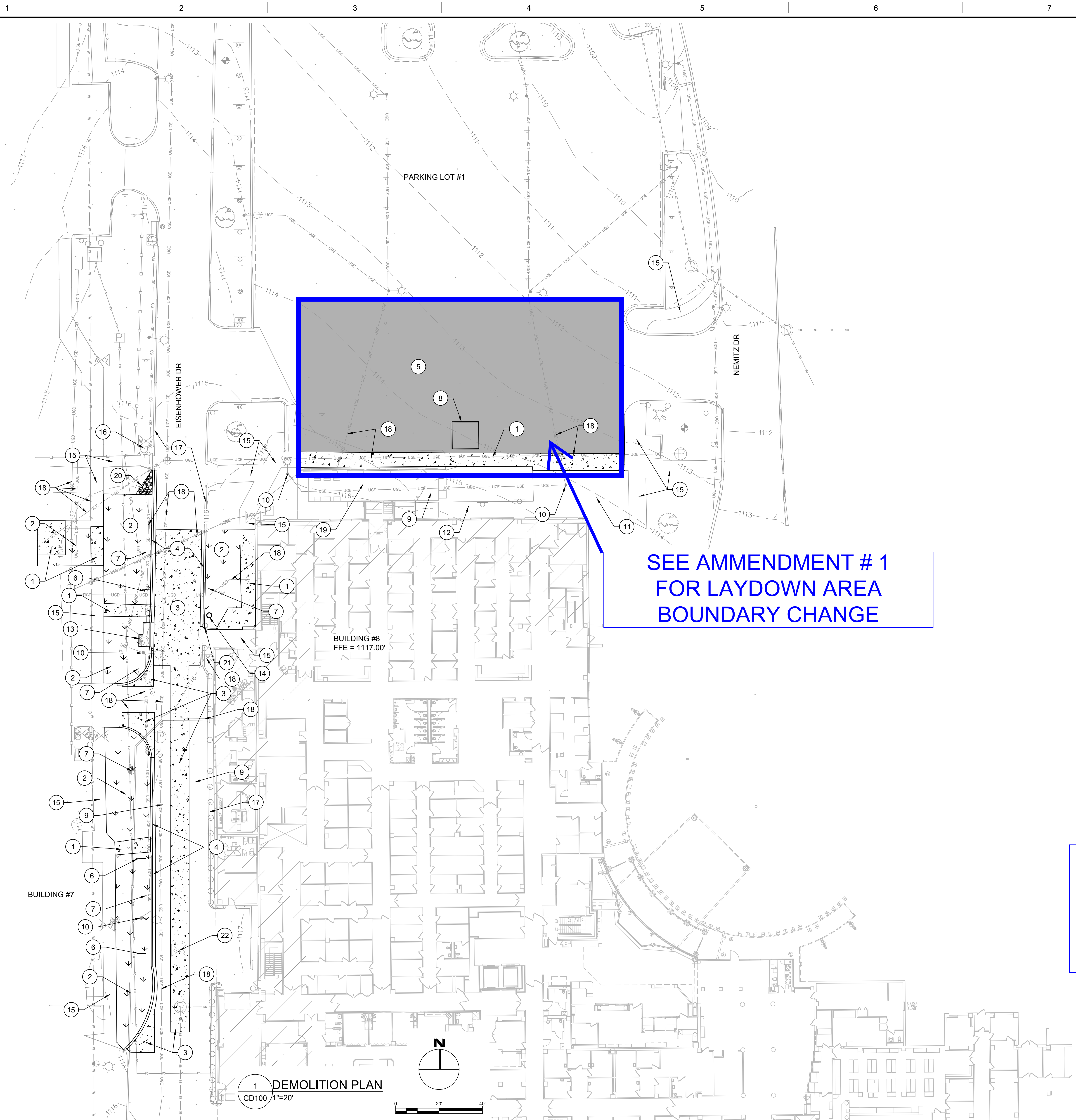

- KEY NOTES**
- 1 REMOVE CONCRETE SIDEWALK AND AGGREGATE BASE - SEE NOTE 1
  - 2 REMOVE SOD AND STOCKPILE TOPSOIL - SEE NOTE 8
  - 3 REMOVE CONCRETE PAVEMENT AND AGGREGATE BASE - SEE NOTE 1
  - 4 REMOVE CONCRETE CURB AND GUTTER AND AGGREGATE BASE
  - 5 REMOVE ASPHALT PAVEMENT AND AGGREGATE BASE
  - 6 REMOVE AND RESET SIGN (REFERENCE LOCATION FOR REPLACEMENT)
  - 7 REMOVE AND REPLACE IRRIGATION SYSTEM, THIS AREA
  - 8 MOVE SHELTER TO TEMPORARY LOCATION DESIGNATED BY OWNER
  - 9 EXISTING CONCRETE PAD OR PAVEMENT - DO NOT DISTURB
  - 10 EXISTING LIGHT POLE - DO NOT DISTURB
  - 11 EXISTING TURF - DO NOT DISTURB
  - 12 EXISTING ROCK MULCH - DO NOT DISTURB
  - 13 EXISTING STORM SEWER INLET AND MANHOLE - DO NOT DISTURB
  - 14 REMOVE AND RESET MIRROR (REFERENCE LOCATION FOR REPLACEMENT)
  - 15 EXISTING SIDEWALK - DO NOT DISTURB
  - 16 EXISTING FIRE HYDRANT - DO NOT DISTURB
  - 17 EXISTING CURB AND GUTTER - DO NOT DISTURB
  - 18 EXISTING UTILITIES - DO NOT DISTURB
  - 19 MRI TRUCK LOCATION - SEE NOTE 9
  - 20 REMOVE GRAVEL SURFACING
  - 21 EXISTING BOLLARD - DO NOT DISTURB
  - 22 REMOVE AND RESET ROOF DRAIN / CLEANOUT - SEE SHEET CU100

- NOTES**
- 1. CONCRETE SHALL BE REMOVED AT FULL PANELS UNLESS APPROVED BY COR. JOINT LOCATIONS ARE APPROXIMATE.
  - 2. OWNER SHALL HAVE FIRST RIGHTS TO ALL SALVAGED MATERIALS. COORDINATE WITH OWNER AND TRANSPORT SALVAGED ITEMS TO THE OWNER DESIGNATED STORAGE AREA. IF OWNER RETAINED, ALL OTHER ITEMS SHALL BE HAULED AND DISPOSED OF OFF-SITE BY THE CONTRACTOR.
  - 3. COORDINATE ALL DEMOLITION OPERATIONS AND REMOVAL OF DEBRIS WITH THE OWNER.
  - 4. ALL EROSION CONTROL BMPs SHALL BE IN PLACE PRIOR TO DEMOLITION.
  - 5. DO NOT DISTURB ANY STRUCTURES NOT DESIGNATED TO BE REMOVED.
  - 6. CONTRACTOR MUST CONFIRM FLOOR ELEVATIONS BEFORE STARTING DEMOLITION WORK. REPORT ANY DISCREPANCIES TO COR.
  - 7. SEE ARCHITECTURE FOR DEMOLITION OF BUILDING.
  - 8. REMOVE ALL TOPSOIL WITHIN GRADING LIMITS AND TEMPORARILY STOCKPILE FOR SPREADING AT COMPLETION OF PROJECT.
  - 9. EXISTING MRI TRUCK WILL BE MOVED BY OWNER PRIOR TO START OF PROJECT.

- LEGEND**
- ASPHALT PAVEMENT
  - CONCRETE PAVEMENT / SIDEWALK
  - IRRIGATED SOD AND TOPSOIL

**AFFECTED KEY NOTES & NOTES  
TO ADJUST TO MEET  
AMMENDMENT # 1  
FOR LAYDOWN AREA  
BOUNDARY CHANGE**

CONSTRUCTION DOCUMENTS

<b>CONSULTANTS:</b>  TERRASITE DESIGN 1635 DEADWOOD AVENUE RAPID CITY, SOUTH DAKOTA 57702 PH: (605) 791-1736  ALBERTSON ENGINEERING, INC. 315 NORTH MAIN AVENUE, SUITE 200 SIOUX FALLS, SOUTH DAKOTA 57104 PH: (605) 274-0880  FARRIS ENGINEERING 12700 WEST DODGE ROAD OMAHA, NEBRASKA 68154 PH: (402) 330-5900		<b>ARCHITECT</b>  FOURFRONT DESIGN, INC. 517 7TH STREET RAPID CITY, SOUTH DAKOTA 57701 PH: (605) 342-9470 FAX: (605) 342-2377 WWW.FOURFRONTDESIGN.COM 16.2330.A08		<b>Project Title</b> Design/Construct Sterile Processing Service- Omaha VA Medical Center <b>Project Number</b> 16.2330.A08 <b>Building Number</b> 25 <b>Drawing Number</b> CD100 Dwg. 12 of 193		<b>Office of Construction and Facilities Management</b>  Department of Veterans Affairs	
<b>COMPLIANCY REVIEW INCLUDED</b> Revisions: Date: 2/23/2024		<b>Drawing Title</b> DEMOLITION PLAN Approved: Project Director Omaha VA Medical Center		<b>Location</b> 4101 Woolworth Ave #4199 Omaha, Ne 68105 <b>Date</b> 11/23/2020 <b>Checked</b> SM <b>Drawn</b> JM			



three inches = one foot  
one and one half inches = one foot  
one inch = one foot  
three quarters inch = one foot  
one half inch = one foot  
three eighths inch = one foot  
one quarter inch = one foot  
one eighth inch = one foot

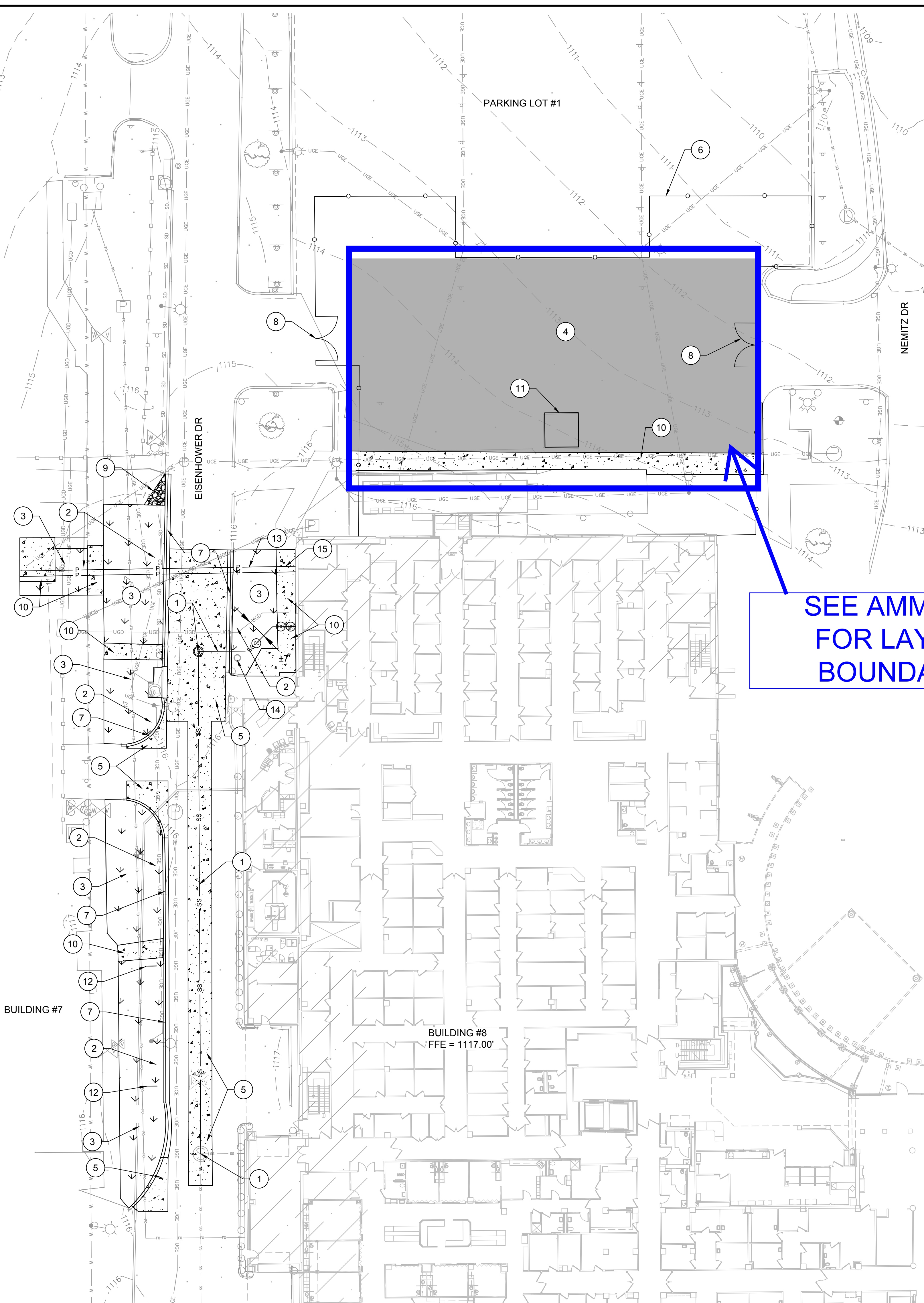

**LEGEND**

- CHAINLINK CONSTRUCTION FENCE
- SANITARY SEWER PIPE
- SANITARY SEWER MANHOLE
- CLEANOUT
- ASPHALT PAVEMENT
- GRAVEL SURFACING
- CONCRETE PAVEMENT / SIDEWALK
- SOD AND TOPSOIL

- KEY NOTES**
- 1. PROPOSED SANITARY SEWER MAIN - SEE CU100 AND NOTE 7
  - 2. REPLACE IRRIGATION SYSTEM, THIS AREA
  - 3. SOD AND TOPSOIL, THIS AREA - SEE NOTE 2
  - 4. ASPHALT PAVEMENT, MATCH EXISTING THICKNESS OR DETAIL, WHICHEVER IS LESS - SEE E4/C-500
  - 5. CONCRETE PAVEMENT - SEE F4/C-501 AND NOTES 1 AND 5
  - 6. CHAINLINK CONSTRUCTION FENCE - SEE NOTE 4
  - 7. CURB AND GUTTER, MATCH EXISTING - SEE A1/C-500, A4/C-500, F4/C-501 AND NOTE 3
  - 8. 16" DOUBLE SWING (8' LEAFS) OR 16' ROLLING GATE
  - 9. REPLACE PERMANENT GRAVEL AT COMPLETION OF SANITARY SEWER INSTALLATION PHASE, MATCH EXISTING
  - 10. CONCRETE SIDEWALK, MATCH EXISTING THICKNESS OR DETAIL, WHICHEVER IS LESS - SEE E1/C-500 AND NOTES 1 AND 5
  - 11. RESET SHELTER AT ORIGINAL LOCATION AT TERMINATION OF PROJECT
  - 12. RESET SIGN
  - 13. PROPOSED ELECTRIC DUCT BANK - SEE E-007
  - 14. RESET MIRROR
  - 15. PROPOSED ELECTRICAL DUCT BANK - SEE NOTES 6 AND 7

- NOTES**
- 1. CONCRETE JOINTS SHALL MATCH EXISTING CONCRETE PAVEMENT AND SIDEWALK.
  - 2. CONTRACTOR SHALL SALVAGE AND REUSE ON-SITE TOPSOIL. IF ENOUGH TOPSOIL IS NOT SALVAGED FROM ON-SITE, CONTRACTOR WILL BE RESPONSIBLE FOR SUPPLEMENTING WITH OFF-SITE TOPSOIL TO PROVIDE A MINIMUM 4" BENEATH ALL TURF. ALL FINISH GRADES OF TURF SHALL PROVIDE POSITIVE DRAINAGE AWAY FROM STRUCTURES AND BE SIMILAR TO EXISTING.
  - 3. PAINT CURB; MATCH EXISTING COLOR; COORDINATE AND OBTAIN PAINT FROM OWNER.
  - 4. TEMPORARY CONSTRUCTION SAFETY FENCE, 8'-0" CHAIN LINK FENCE WITH OPAQUE SCREEN (98% OPAQUENESS OR GREATER).
  - 5. CONCRETE SHALL BE REMOVED AT FULL PANELS UNLESS APPROVED BY COR.
  - 6. CONTRACTOR TO CONFIRM ALIGNMENT WITH OWNER OR COR PRIOR TO STARTING CONSTRUCTION.
  - 7. PROPOSED ELECTRICAL DUCT BANK AND SANITARY SEWER SERVICE / MAIN CANNOT BE CONSTRUCTED AT SAME TIME AS THE ELECTRICAL DUCT BANK WOULD CONFLICT WITH TRAFFIC CONTROL PLAN.

**AFFECTED KEY NOTES & NOTES  
TO ADJUST TO MEET  
AMMENDMENT # 1  
FOR LAYDOWN AREA  
BOUNDARY CHANGE**

1 SITE PLAN  
CS100 1"=20'

<b>CONSULTANTS:</b>  TERRASITE DESIGN 1635 DEADWOOD AVENUE RAPID CITY, SOUTH DAKOTA 57702 PH: (605) 791-1736  ALBERTSON ENGINEERING, INC. 315 NORTH MAIN AVENUE, SUITE 200 SIOUX FALLS, SOUTH DAKOTA 57104 PH: (605) 274-0880  FARRIS ENGINEERING 12700 WEST DODGE ROAD OMAHA, NEBRASKA 68154 PH: (402) 330-5900		<b>ARCHITECT</b>  FOURFRONT DESIGN, INC. 517 7TH STREET RAPID CITY, SOUTH DAKOTA 57701 PH: (605) 342-9470 FAX: (605) 342-2377 WWW.FOURFRONTDESIGN.COM		<b>16.2330.A08</b>	
<b>COMPLIANCE REVIEW INCLUDED</b> Revisions: 2/23/2024 Date		<b>16.2330.A08</b>		<b>16.2330.A08</b>	

<b>Drawing Title</b> SITE PLAN		<b>Project Title</b> Design/Construct Sterile Processing Service- Omaha VA Medical Center		<b>Project Number</b> 16.2330.A08 <b>Building Number</b> 25	
<b>Approved: Project Director</b> Omaha VA Medical Center		<b>Location</b> 4101 Woolworth Ave #4199 Omaha, Ne 68105		<b>Drawing Number</b> CS100 Dwg. 13 of 193	
<b>Date</b> 11/23/2020		<b>Checked</b> SM		<b>Drawn</b> JM	

Office of Construction and Facilities Management  
Department of Veterans Affairs



three inches = one foot  
one and one half inches = one foot  
one inch = one foot  
three quarters inch = one foot  
one half inch = one foot  
three eighths inch = one foot  
one quarter inch = one foot  
one eighth inch = one foot

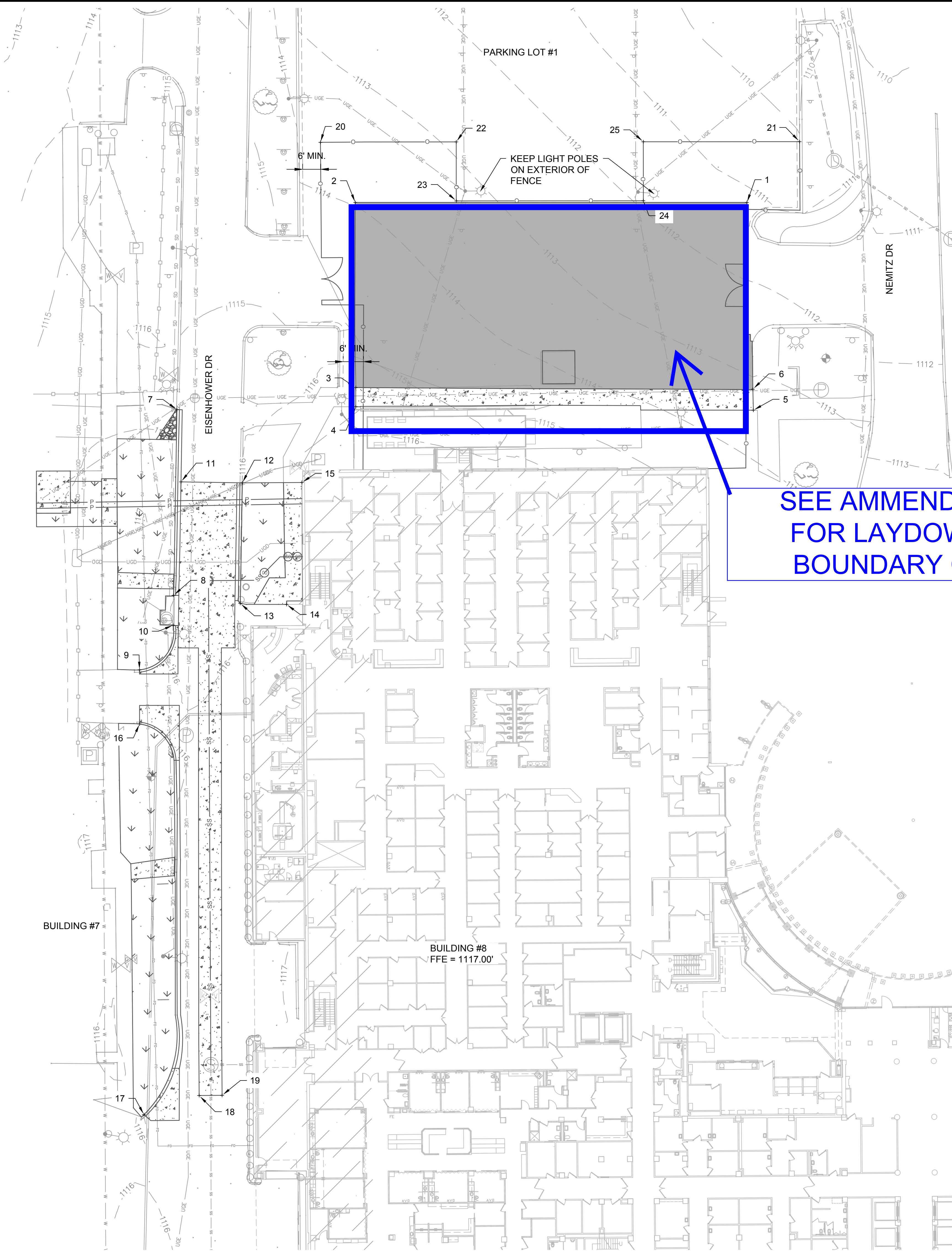

SEE AMMENDMENT # 1  
FOR LAYDOWN AREA  
BOUNDARY CHANGE

Point Table			
Point #	Northing	Easting	Description
1	10859.65	20467.52	ME
2	10859.65	20319.62	ME
3	10789.75	20319.79	ME
4	10782.51	20319.81	ME
5	10781.20	20469.93	ME
6	10789.14	20469.75	ME
7	10781.40	20252.30	ME
8	10711.29	20251.02	ME
9	10683.15	20238.15	ME
10	10699.99	20250.85	ME
11	10754.14	20253.83	ME
12	10753.78	20276.98	ME
13	10708.27	20276.17	ME
14	10707.85	20293.70	ME
15	10753.90	20299.49	ME
16	10662.72	20238.17	ME
17	10515.18	20239.83	ME
18	10522.43	20260.67	ME
19	10522.49	20269.34	ME
20	10882.35	20306.48	FENCE
21	10882.61	20487.39	FENCE
22	10882.51	20357.75	FENCE

Point Table			
Point #	Northing	Easting	Description
23	10860.24	20357.77	FENCE
24	10860.29	20428.40	FENCE
25	10882.56	20428.39	FENCE

ABBREVIATIONS  
ME = MATCH EXISTING

- NOTES
- STAKE OUT POINTS ARE PROVIDED TO SHOW APPROXIMATE PROJECT LIMITS.
  - CONCRETE SHALL BE REMOVED AT FULL PANELS UNLESS APPROVED BY COR. JOINT LOCATIONS ARE APPROXIMATE.

AFFECTED KEY NOTES & NOTES  
TO ADJUST TO MEET  
AMMENDMENT # 1  
FOR LAYDOWN AREA  
BOUNDARY CHANGE

1 GRADING AND STAKEOUT PLAN  
CG100 1"=20'

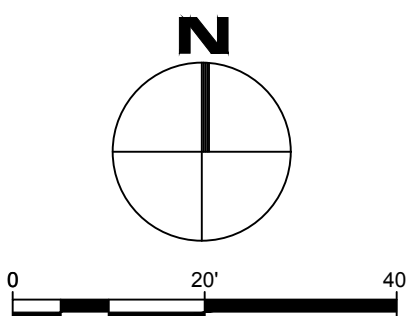

COMPLIANCE REVIEW INCLUDED	2/23/2024
Revisions:	Date

CONSULTANTS:

TERRASITE DESIGN  
1635 DEADWOOD AVENUE  
RAPID CITY, SOUTH DAKOTA 57702  
PH: (605) 791-1736

ALBERTSON ENGINEERING, INC.  
315 NORTH MAIN AVENUE, SUITE 200  
SIOUX FALLS, SOUTH DAKOTA 57104  
PH: (605) 274-0880

FARRIS ENGINEERING  
12700 WEST DODGE ROAD  
OMAHA, NEBRASKA 68154  
PH: (402) 330-5900



ARCHITECT

FOURFRONT DESIGN, INC.  
517 7TH STREET  
RAPID CITY, SOUTH DAKOTA  
57701  
PH: (605) 342-9470  
FAX: (605) 342-2377  
WWW.FOURFRONTDESIGN.COM

16.2330.A08

Drawing Title

GRADING AND STAKEOUT PLAN

Approved: Project Director  
Omaha VA Medical Center

Project Title

Design/Construct Sterile  
Processing Service- Omaha VA  
Medical Center

Location 4101 Woolworth Ave #4199  
Omaha, Ne 68105

Date 11/23/2020

Checked SM

Drawn JM

Project Number

16.2330.A08

Building Number

25

Drawing Number

CG100

Dwg. 14 of 193

Office of  
Construction and Facilities  
Management

Department of  
Veterans Affairs



8/2/2020 11:42:28 AM

one eighth inch = one foot  
0 4 8 16

one quarter inch = one foot  
0 4 8

three eighths inch = one foot  
0 4 8

one half inch = one foot  
0 6

three quarters inch = one foot  
0 6

one inch = one foot  
0 6

one and one half inches = one foot  
0 6

three inches = one foot  
0 6

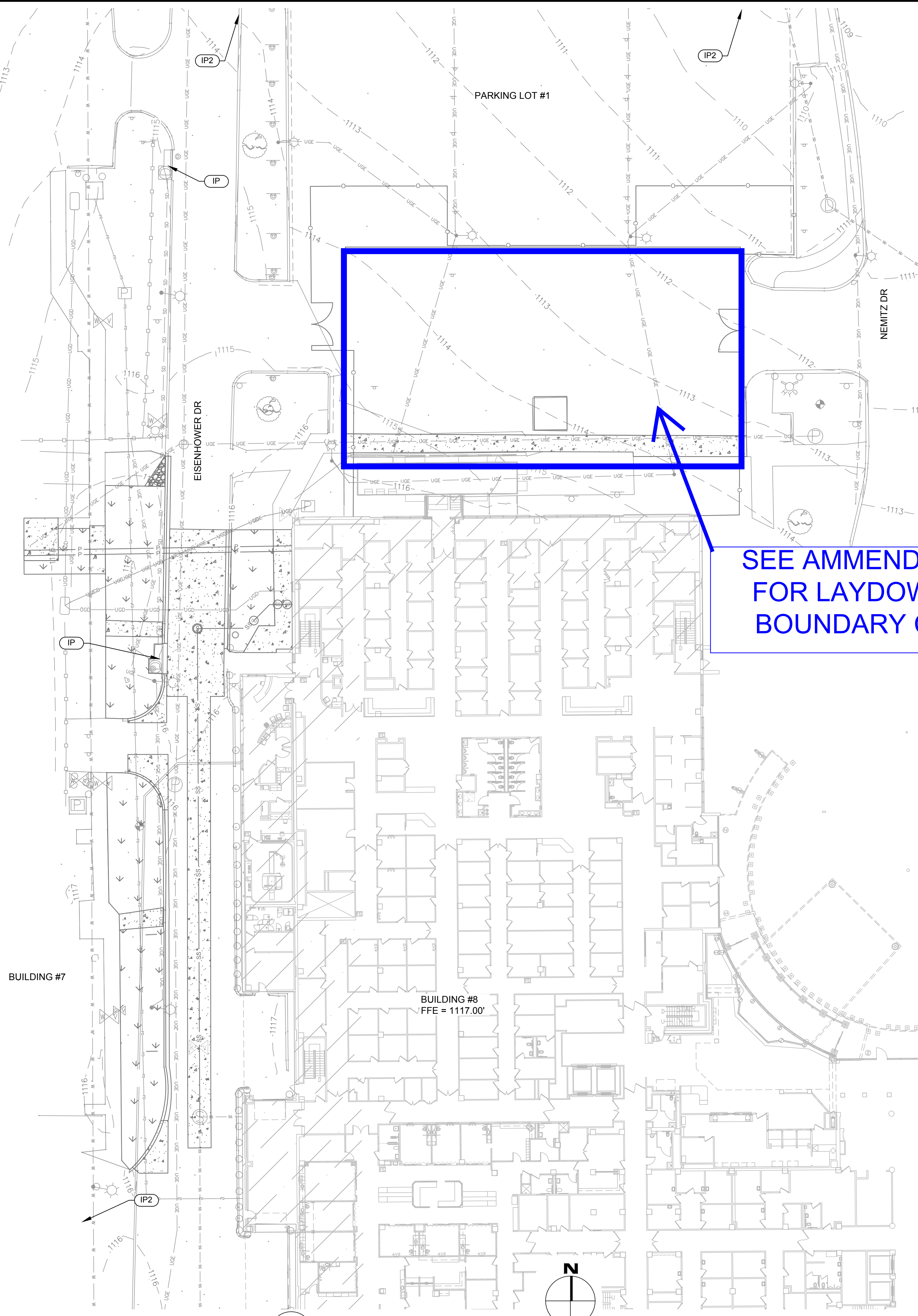

EROSION CONTROL / STORM WATER POLLUTION CONTROL -  
THE CONTRACTOR IS NOT REQUIRED TO OBTAIN A GENERAL  
STORMWATER PERMIT FROM THE NEBRASKA DEPARTMENT OF  
ENVIRONMENT AND ENERGY (DEE) AS THE PROJECT WILL NOT DISTURB  
MORE THAN 1 ACRE OF LAND.

THE CONTRACTOR SHALL ALSO COMPLY WITH ANY CITY OF OMAHA  
EROSION AND SEDIMENT CONTROL REQUIREMENTS.

THE CONTRACTOR SHALL NOT BEGIN ANY SURFACE REMOVAL OR  
EXCAVATION UNTIL EROSION CONTROL MEASURES ARE IN PLACE FOR  
THE PHASE OF WORK BEING COMPLETED. EROSION CONTROL  
MEASURES SHALL PROCEED IN AN ORDERLY AND PROGRESSIVE  
MANNER AHEAD OF EXCAVATION WORK.

THE CONTRACTOR IS ADVISED THAT SEVERAL AGENCIES INCLUDING  
THE OWNER HAVE THE AUTHORITY TO "STOP WORK" IF THE POLLUTION  
PREVENTION CONTROL IS NOT IMPLEMENTED OR IS NOT EFFECTIVE IN  
PREVENTION OF ENVIRONMENTAL DAMAGE FROM CONSTRUCTION  
ACTIVITIES. NO COMPENSATION WILL BE FORTHCOMING FOR "LOST  
TIME" DUE TO A "STOP WORK" ORDER.

LOCATIONS FOR THE EROSION CONTROL MEASURES ARE  
RECOMMENDED ON THE PLANS. IT SHALL BE THE RESPONSIBILITY OF  
THE CONTRACTOR TO DETERMINE THE DEVICES AND LOCATIONS  
NECESSARY FOR EFFECTIVE POLLUTION CONTROL IN ACCORDANCE  
WITH CITY, STATE, AND FEDERAL POLLUTION CONTROL REQUIREMENTS.

ALL STORM DRAIN INLETS SHALL BE PROTECTED BY APPROPRIATE BMPs  
DURING CONSTRUCTION UNTIL ALL SOURCES WITH POTENTIAL FOR  
DISCHARGING TO THE INLET HAVE BEEN STABILIZED.

THE CONTRACTOR SHALL FOLLOW THIS EROSION CONTROL PLAN TO  
ADDRESS POTENTIAL RUNOFF OF SURFACE WATERS CONTAINING  
SEDIMENT TO WATERS OF THE STATE. THE CONTRACTOR IS  
RESPONSIBLE FOR IMPLEMENTATION OF THIS PLAN. THIS PLAN, AS  
WELL AS IMPLEMENTATION, IS DESIGNED TO MINIMIZE THESE IMPACTS  
AND ADDRESS POTENTIAL PROBLEMS.

THE CONTRACTOR SHALL BE HELD RESPONSIBLE FOR REMEDIATION OF  
ANY ADVERSE IMPACTS TO STORM SEWER, ADJACENT WATERWAYS,  
WETLANDS, ETC., RESULTING FROM WORK DONE AS PART OF THIS  
PROJECT.

THE CONTRACTOR WILL BE REQUIRED TO FIND AN APPROPRIATE  
LOCATION FOR CONCRETE WASHOUT. THE LOCATION WILL REQUIRE  
APPROPRIATE CONTAINMENT FOR THE WASHOUT OPERATIONS.

THE CONTRACTOR, AND / OR THEIR AUTHORIZED AGENTS SHALL  
ENSURE THAT ALL LOADS OF CUT AND FILL MATERIAL IMPORTED TO OR  
EXPORTED FROM THIS SITE SHALL BE PROPERLY COVERED TO PREVENT  
LOSS OF THE MATERIAL DURING TRANSPORT ON PUBLIC RIGHT OF  
WAYS.

INSPECTION AND MAINTENANCE -  
THE CONTRACTOR SHALL INSPECT ALL EROSION CONTROL AND WATER  
POLLUTION CONTROL DEVICES ONCE A WEEK AND WITHIN 24 HOURS OF  
EVERY RAINFALL GREATER THAN 1/2 INCH. THE CONTRACTOR SHALL BE  
RESPONSIBLE FOR MAINTENANCE, TO INCLUDE BUT NOT BE LIMITED TO:  
REPAIR, RESET, MUCKING, REPLACEMENT, OF ALL TEMPORARY EROSION  
CONTROL AND WATER POLLUTION CONTROL DEVICES UNTIL  
PERMANENT EROSION CONTROL IS ESTABLISHED AND THE PROJECT  
HAS BEEN COMPLETED AND ACCEPTED. MAINTENANCE OF EROSION  
CONTROL AND WATER POLLUTION CONTROL DEVICES SHALL BE  
INCIDENTAL AND CONSIDERED PART OF THE UNIT COST.

INSTALL TEMPORARY VEHICLE TRACKING CONTROL OR TIRE WASH OFF  
FACILITY AT ALL LOCATIONS WHERE VEHICLES ENTER FROM PAVEMENT  
INTO CONSTRUCTION SITE. CONSTRUCTION SITE VEHICLE EXIT  
LOCATIONS MUST BE INSPECTED FOR EVIDENCE OF OFF-SITE SEDIMENT  
TRACKING ONTO PAVED SURFACES. TRACKED SEDIMENT MUST BE  
REMOVED FROM ALL OFF-SITE ROADS, WITHIN 24 HOURS OF DISCOVERY.  
CONSTRUCTION SITE VEHICLE EXIT LOCATIONS SHALL BE RELOCATED  
AS NECESSARY DEPENDENT UPON PHASING.

ALL BMPs MUST BE REPAIRED, REPLACED, OR SUPPLEMENTED WHEN  
THEY BECOME NONFUNCTIONAL OR THE SEDIMENT REACHES 1/3 OF THE  
HEIGHT OF THE FENCE. THESE REPAIRS MUST BE MADE WITHIN 24  
HOUR OF DISCOVERY, OR AS SOON AS FIELD CONDITIONS ALLOW  
ACCESS.

TEMPORARY DRAINAGE DURING CONSTRUCTION IS THE CONTRACTOR'S  
RESPONSIBILITY. CONTRACTOR SHALL BE AWARE OF EXISTING  
DRAINAGE CONDITIONS AND FACILITIES, AND SHALL PROVIDE FOR  
DRAINAGE AND EROSION CONTROL DURING ALL PHASES OF  
CONSTRUCTION. DAMAGE CAUSED BY IMPROPER TEMPORARY  
DRAINAGE FACILITIES SHALL BE REPAIRED AT THE CONTRACTOR'S  
EXPENSE TO THE SATISFACTION OF THE OWNER.

#### LEGEND

- (IP) INLET PROTECTION DEVICES - SEE NOTE 3  
(IP2) INSTALL INLET PROTECTION DEVICE AT NEXT DOWNSTREAM INLET

#### NOTES:

1. EROSION CONTROL MEASURES SHOWN ARE BASED ON THE  
ENGINEER'S JUDGEMENT.
2. TEMPORARY EROSION CONTROL DEVICES TO BE REMOVED BY  
CONTRACTOR WHEN SITE IS STABILIZED.
3. INSTALL SEDIMENT FILTERING DEVICES AT STORM DRAIN INLETS.  
INLET PROTECTION SHALL BE A BMP CONSISTING OF A FILTERING  
DEVICE PLACED IN THE MANHOLE THAT INCLUDES AN OVERFLOW  
FEATURE THAT ALLOWS THE BMP TO DRAIN WHEN PLUGGED OR FULL  
AND PREVENTS PONDING AT THE CURB INLETS. BASIS OF DESIGN IS  
FLEXSTORM INLET FILTERS.

**AFFECTED KEY NOTES & NOTES  
TO ADJUST TO MEET  
AMMENDMENT # 1  
FOR LAYDOWN AREA  
BOUNDARY CHANGE**

**SEE AMMENDMENT # 1  
FOR LAYDOWN AREA  
BOUNDARY CHANGE**

## CONSTRUCTION DOCUMENTS

COMPLIANCY REVIEW INCLUDED	2/23/2024
Revisions:	Date

#### CONSULTANTS:



TERRASITE DESIGN  
1635 DEADWOOD AVENUE  
RAPID CITY, SOUTH DAKOTA 57702  
PH: (605) 791-1736



Albertson Engineering Inc.



FARRIS ENGINEERING  
OMAHA (BRANCH) | BENTLEY | COLORADO SPRINGS  
TEL: (402) 330-5900

ALBERTSON ENGINEERING, INC.  
315 NORTH MAIN AVENUE, SUITE 200  
SIOUX FALLS, SOUTH DAKOTA 57104  
PH: (605) 274-0880

FARRIS ENGINEERING  
12700 WEST DODGE ROAD  
OMAHA, NEBRASKA 68154  
PH: (402) 330-5900



#### ARCHITECT



FOURFRONT DESIGN, INC.  
517 7TH STREET  
RAPID CITY, SOUTH DAKOTA  
57701  
PH: (605) 342-9470  
FAX: (605) 342-2377  
WWW.FOURFRONTDESIGN.COM

16.2330.A08

Drawing Title
EROSION CONTROL PLAN
Approved: Project Director
Omaha VA Medical Center

Project Title	Project Number
Design/Construct Sterile Processing Service- Omaha VA Medical Center	16.2330.A08
Location	Building Number
4101 Woolworth Ave #4199 Omaha, Ne 68105	25
Date	Drawing Number
11/23/2020	CG101
Checked	Dwg. 15 of 193
SM	
Drawn	
JM	

Office of Construction and Facilities Management
Department of Veterans Affairs



three inches = one foot  
one and one half inches = one foot  
one inch = one foot  
three quarters inch = one foot  
three eighths inch = one foot  
one quarter inch = one foot  
one eighth inch = one foot

8/2/2020 11:42:28 AM

VA FORM 08-6231

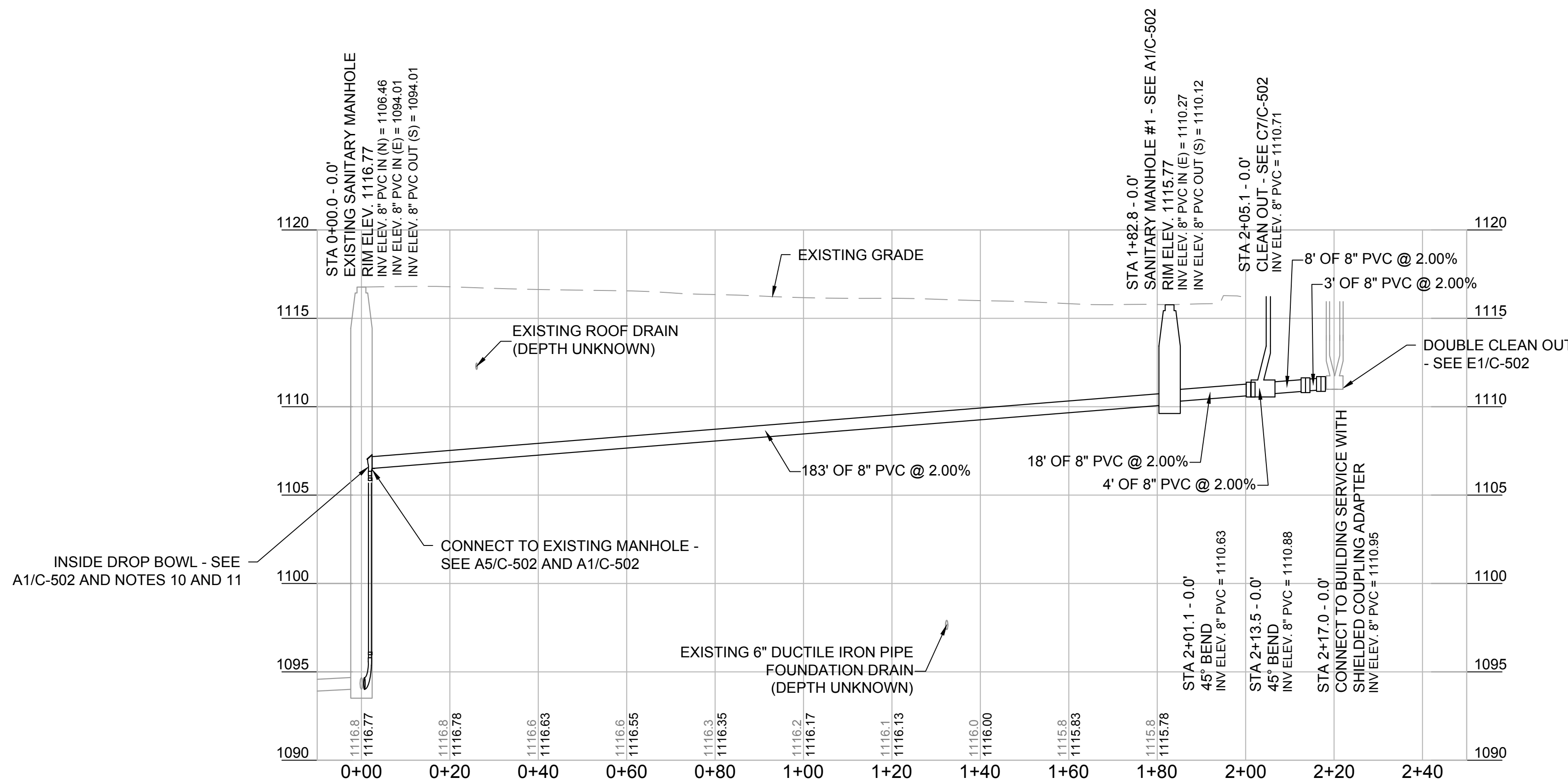
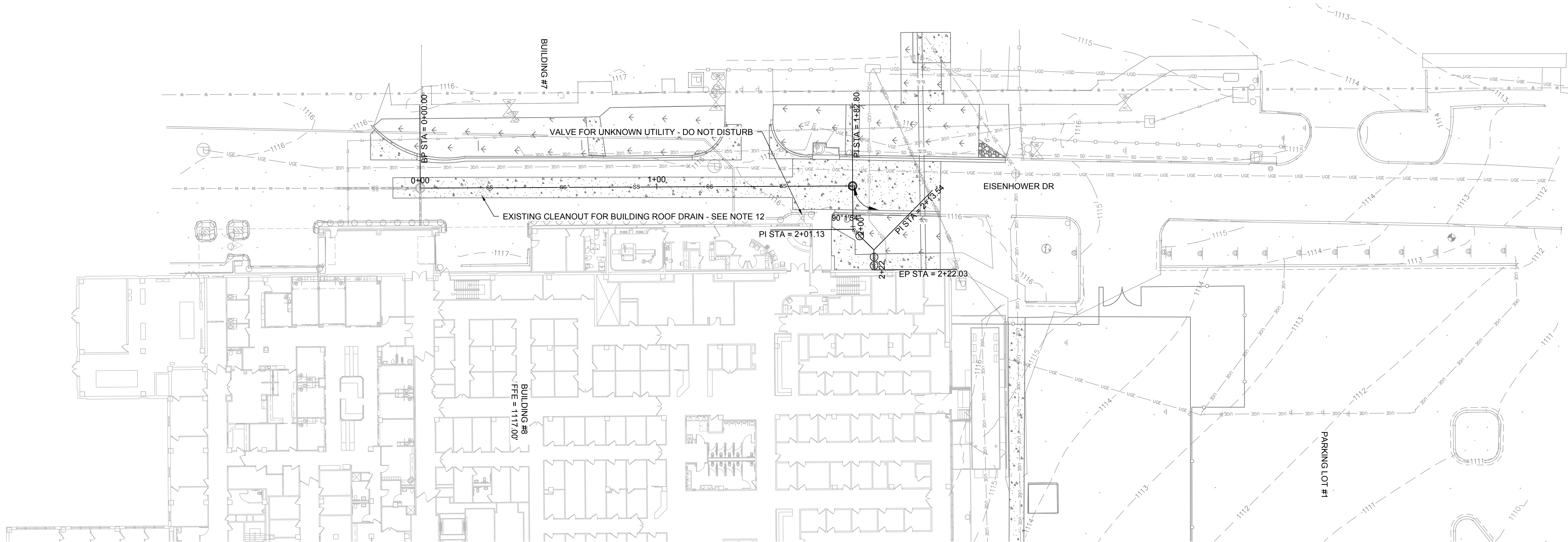

- NOTE:
1. DEPTH OF EXISTING UTILITIES IS UNKNOWN. CONTRACTOR SHALL VERIFY THE LOCATION AND DEPTH OF ALL EXISTING CROSSING UTILITIES PRIOR TO CONSTRUCTION OF THE PROPOSED UTILITY AND ORDERING MATERIALS.
  2. SEE C4/C-502 FOR MANHOLE DETAIL.
  3. SEE E1/C-502 FOR CLEAN OUT DETAIL.
  4. IF LESS THAN 18" OF VERTICAL CLEARANCE IS PROVIDED BETWEEN WATER MAIN AND STORM / SANITARY SEWER OR IF WATER MAIN IS BENEATH STORM / SANITARY SEWER, ENCASE AS PER NDEE REQUIREMENTS - SEE F8/C-502
  5. CONTRACTOR TO ENSURE PROTECTION OF ALL UNDERGROUND UTILITIES DURING CONSTRUCTION.
  6. MAINTAIN A MINIMUM OF 1' VERTICAL SEPARATION.
  7. CONTRACTOR MAY REVISE SLOPE OR ELEVATION OF SANITARY SERVICE FROM BUILDING TO MANHOLE TO MAINTAIN CLEARANCES SHOWN IN NOTE 4 AND NOTE 5 WITH APPROVAL OF CO. MAINTAIN A MINIMUM OF 2% SLOPE ON ALL SANITARY SEWER SERVICE AND MAINS OUTSIDE OF BUILDING.
  8. SEE A8/C-502 FOR TRENCH DETAIL.
  9. CONTRACTOR IS RESPONSIBLE FOR ALL BYPASS PUMPING IN ACCORDANCE WITH CITY OF OMAHA AND NDEE REQUIREMENTS WHICH INCLUDES A BYPASS PUMPING PLAN.
  10. CONTRACTOR TO USE EXTREME CAUTION AS MANHOLE IS VERY DEEP. CONTRACTOR SHALL FOLLOW OSHA REGULATIONS REGARDING CONFINED SPACES.
  11. BASIS FOR DESIGN IS RELINER OR PRE-APPROVED EQUAL. INSTALL INSIDE DROP CONNECTION AS PER MANUFACTURER INSTRUCTIONS.
  12. REMOVE AND RESET EXISTING ROOF DRAIN / CLEANOUT AS NECESSARY TO INSTALL SANITARY SEWER MAIN. SUPPORT EXISTING UTILITY DURING CONSTRUCTION.
  13. USE OF TRENCH BOX FOR INSTALLATION OF SANITARY SEWER IS HIGHLY RECOMMENDED AND LIKELY NECESSARY.
  14. EXISTING DUCT BANK IN CLOSE PROXIMITY TO PROPOSED SANITARY SEWER SERVICE. CONTRACTOR TO VERIFY DEPTH AND LOCATION OF EXISTING DUCT BANK PRIOR TO STARTING CONSTRUCTION OF SANITARY SEWER SERVICE. CONTRACTOR TO REPORT ANY CONFLICTS TO COR. PROTECT EXISTING DUCT BANK FROM DAMAGE.

1 SANITARY SEWER PLAN  
CU100 1"=20'

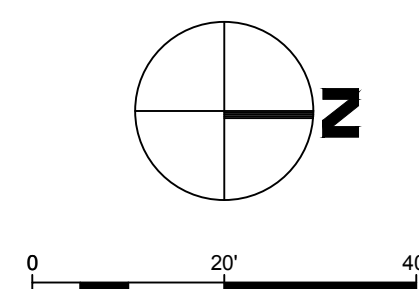

CONSTRUCTION DOCUMENTS

<b>CONSULTANTS:</b>		<b>ARCHITECT</b>		<b>Drawing Title</b>		<b>Project Title</b>		<b>Project Number</b>		<b>Office of Construction and Facilities Management</b>			
 TERRASITE DESIGN 1635 DEADWOOD AVENUE RAPID CITY, SOUTH DAKOTA 57702 PH: (605) 791-1736		 ALBERTSON ENGINEERING, INC. 315 NORTH MAIN AVENUE, SUITE 200 SIOUX FALLS, SOUTH DAKOTA 57104 PH: (605) 274-0880		 FOURFRONT DESIGN, INC. 517 7TH STREET RAPID CITY, SOUTH DAKOTA 57701 PH: (605) 342-9470 FAX: (605) 342-2377 WWW.FOURFRONTDESIGN.COM		SANITARY SEWER PLAN		Design/Construct Sterile Processing Service- Omaha VA Medical Center			16.2330.A08		
 FARRIS ENGINEERING 12700 WEST DODGE ROAD OMAHA, NEBRASKA 68154 PH: (402) 330-5900				Approved: Project Director Omaha VA Medical Center		Location 4101 Woolworth Ave #4199 Omaha, Ne 68105		Building Number 25			Drawing Number CU100		
COMPLIANCY REVIEW INCLUDED		2/23/2024		Date		Date 11/23/2020		Checked SM		Drawn JM		Dwg. 16 of 193	



8/2/2020 11:42:26 AM

one eighth inch = one foot  
0 4 8 16

one quarter inch = one foot  
0 4 8

three eighths inch = one foot  
0 4 8

one half inch = one foot  
0 4 8

three quarters inch = one foot  
0 4 8

one inch = one foot  
0 4 8

one and one half inches = one foot  
0 4 8

three inches = one foot  
0 4 8

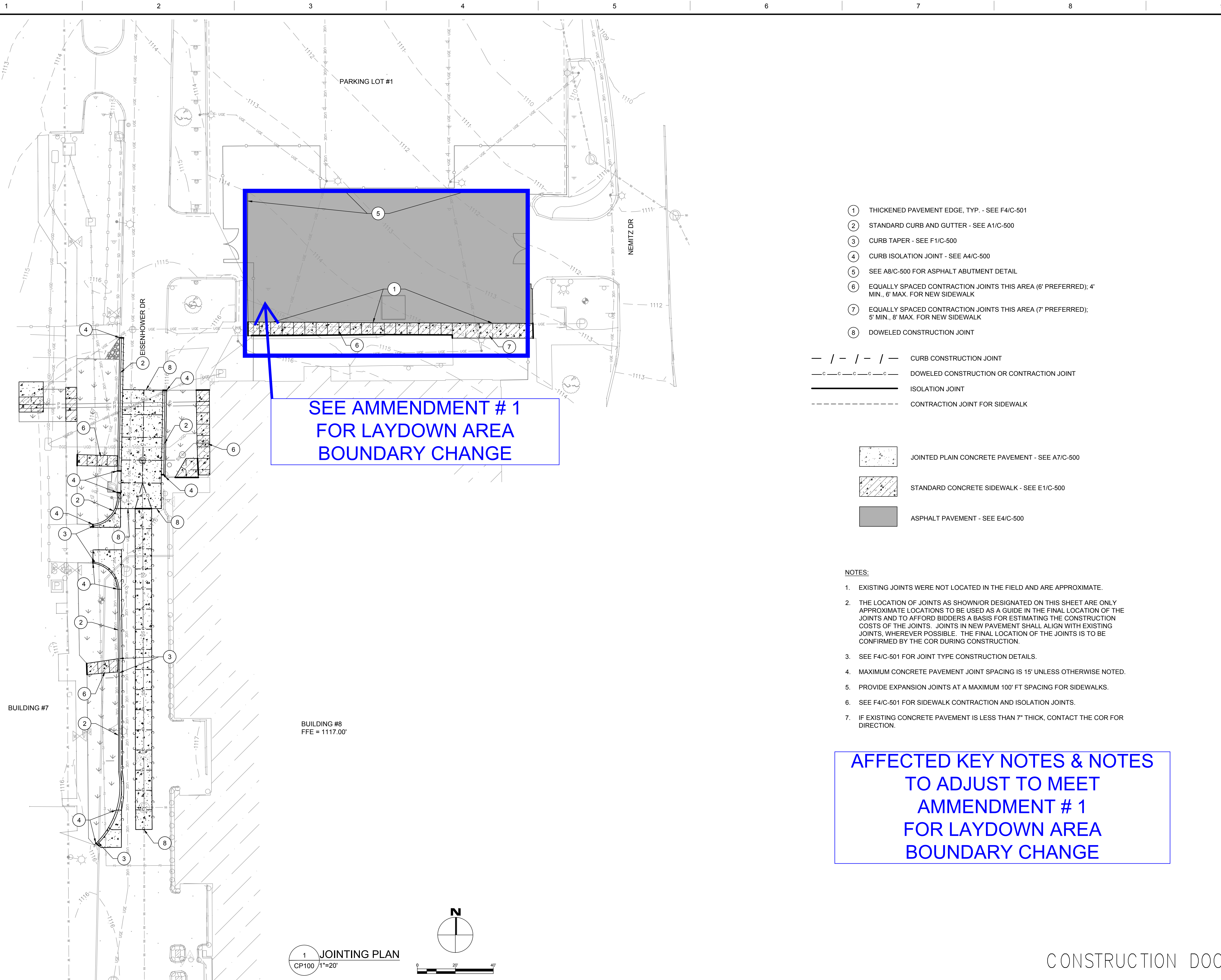

<div>COMPLIANCY REVIEW INCLUDED</div> <div>Revisions:</div>		<div>2/23/2024</div> <div>Date</div>	<div>CONSULTANTS:</div> <div><div><div>TERRASITE DESIGN</div><div>1635 DEADWOOD AVENUE</div><div>RAPID CITY, SOUTH DAKOTA 57702</div><div>PH: (605) 791-1736</div></div><div><div>Albertson Engineering Inc.</div><div></div></div><div><div>FARRIS ENGINEERING</div><div>OMAHA (BRICK) &amp; NEMITZ (CONCRETE) PROJECTS</div><div>PH: (402) 330-5900</div></div><div><div>ALBERTSON ENGINEERING, INC.</div><div>315 NORTH MAIN AVENUE, SUITE 200</div><div>SIOUX FALLS, SOUTH DAKOTA 57104</div><div>PH: (605) 274-0880</div></div></div>		<div>ARCHITECT</div> <div><div>FOURFRONT DESIGN, INC.</div><div>517 7TH STREET</div><div>RAPID CITY, SOUTH DAKOTA 57701</div><div>PH: (605) 342-9470</div><div>FAX: (605) 342-2377</div><div>WWW.FOURFRONTDESIGN.COM</div></div>	<div>16.2330.A08</div>	<div>Drawing Title</div> <div>JOINTING PLAN</div> <div>Approved: Project Director</div> <div>Omaha VA Medical Center</div>	<div>Project Title</div> <div>Design/Construct Sterile Processing Service- Omaha VA Medical Center</div> <div>Location 4101 Woolworth Ave #4199 Omaha, Ne 68105</div> <div>Date 11/23/2020</div> <div>Checked SM</div> <div>Drawn JM</div>	<div>Project Number</div> <div>16.2330.A08</div> <div>Building Number</div> <div>25</div> <div>Drawing Number</div> <div>CP100</div> <div>Dwg. 17 of 193</div>	<div>Office of Construction and Facilities Management</div> <div>Department of Veterans Affairs</div>
---	--	--------------------------------------	--	--	--	------------------------	--	--	--	---







8/2/2020 11:42:26 AM

three eighths inch = one foot  
one eighth inch = one foot  
one quarter inch = one foot  
three quarters inch = one foot  
one inch = one foot  
one and one half inches = one foot  
two inches = one foot  
three inches = one foot  
four inches = one foot  
five inches = one foot  
six inches = one foot  
seven inches = one foot  
eight inches = one foot  
nine inches = one foot  
ten inches = one foot  
eleven inches = one foot  
twelve inches = one foot  
thirteen inches = one foot  
fourteen inches = one foot  
fifteen inches = one foot  
sixteen inches = one foot  
seventeen inches = one foot  
eighteen inches = one foot  
nineteen inches = one foot  
twenty inches = one foot  
twenty one inches = one foot  
twenty two inches = one foot  
twenty three inches = one foot  
twenty four inches = one foot  
twenty five inches = one foot  
twenty six inches = one foot  
twenty seven inches = one foot  
twenty eight inches = one foot  
twenty nine inches = one foot  
thirty inches = one foot  
thirty one inches = one foot  
thirty two inches = one foot  
thirty three inches = one foot  
thirty four inches = one foot  
thirty five inches = one foot  
thirty six inches = one foot  
thirty seven inches = one foot  
thirty eight inches = one foot  
thirty nine inches = one foot  
forty inches = one foot  
forty one inches = one foot  
forty two inches = one foot  
forty three inches = one foot  
forty four inches = one foot  
forty five inches = one foot  
forty six inches = one foot  
forty seven inches = one foot  
forty eight inches = one foot  
forty nine inches = one foot  
fifty inches = one foot  
fifty one inches = one foot  
fifty two inches = one foot  
fifty three inches = one foot  
fifty four inches = one foot  
fifty five inches = one foot  
fifty six inches = one foot  
fifty seven inches = one foot  
fifty eight inches = one foot  
fifty nine inches = one foot  
sixty inches = one foot  
sixty one inches = one foot  
sixty two inches = one foot  
sixty three inches = one foot  
sixty four inches = one foot  
sixty five inches = one foot  
sixty six inches = one foot  
sixty seven inches = one foot  
sixty eight inches = one foot  
sixty nine inches = one foot  
seventy inches = one foot  
seventy one inches = one foot  
seventy two inches = one foot  
seventy three inches = one foot  
seventy four inches = one foot  
seventy five inches = one foot  
seventy six inches = one foot  
seventy seven inches = one foot  
seventy eight inches = one foot  
seventy nine inches = one foot  
eighty inches = one foot  
eighty one inches = one foot  
eighty two inches = one foot  
eighty three inches = one foot  
eighty four inches = one foot  
eighty five inches = one foot  
eighty six inches = one foot  
eighty seven inches = one foot  
eighty eight inches = one foot  
eighty nine inches = one foot  
ninety inches = one foot  
ninety one inches = one foot  
ninety two inches = one foot  
ninety three inches = one foot  
ninety four inches = one foot  
ninety five inches = one foot  
ninety six inches = one foot  
ninety seven inches = one foot  
ninety eight inches = one foot  
ninety nine inches = one foot  
one hundred inches = one foot

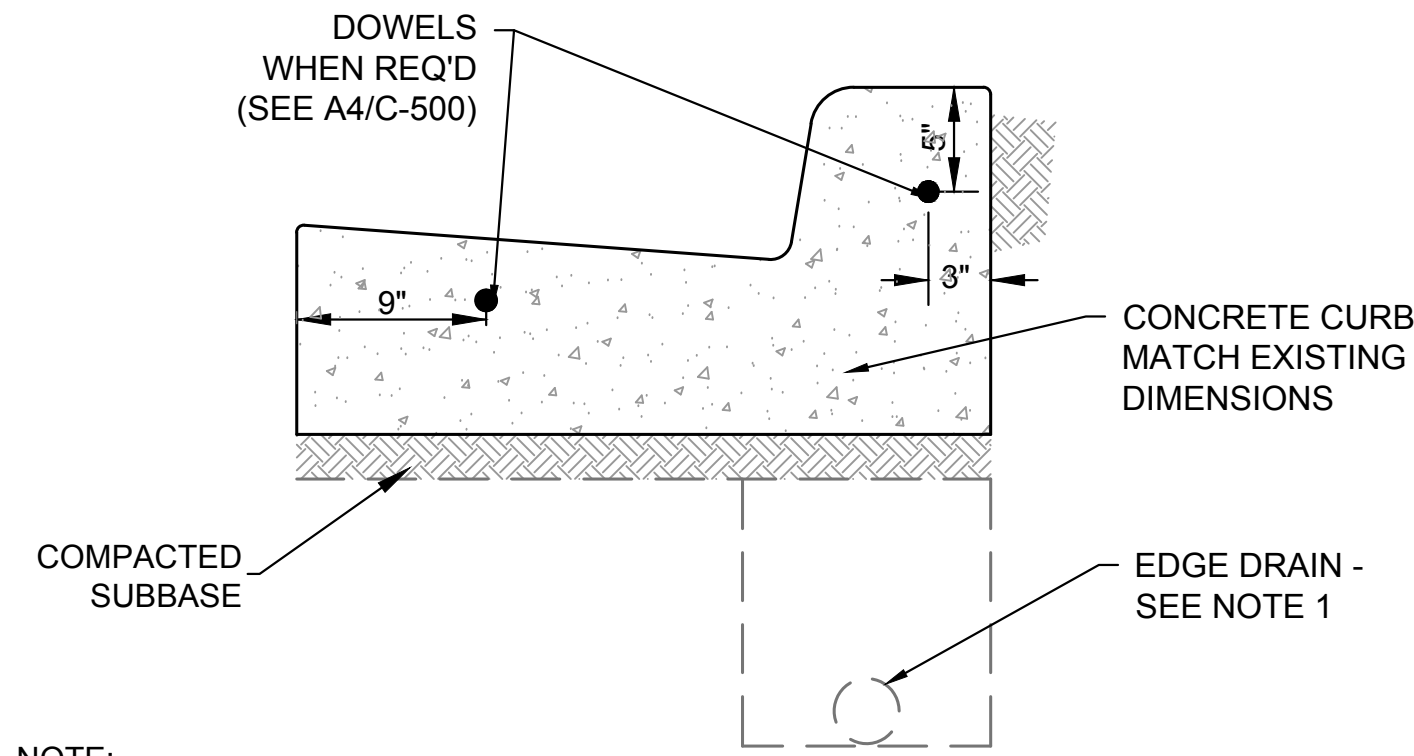

NOTE:  
1. IF EXISTING EDGE DRAIN IS PRESENT, CONTRACTOR SHALL PROVIDE EDGE DRAIN IN CONFORMANCE WITH TYPE 1 OR TYPE 2 OF CITY OF OMAHA STANDARD PLATE 305-01. ALL MATERIALS SHALL BE IN ACCORDANCE WITH CURRENT VERSION OF THE CITY OF OMAHA STANDARD SPECIFICATIONS FOR PUBLIC WORKS CONSTRUCTION 3RD EDITION. CONNECT TO EXISTING EDGE DRAIN. CONTRACTOR SHALL PROVIDE POSITIVE DRAINAGE.

A1 CURB TYPICAL SECTIONS  
C-500 N.T.S.

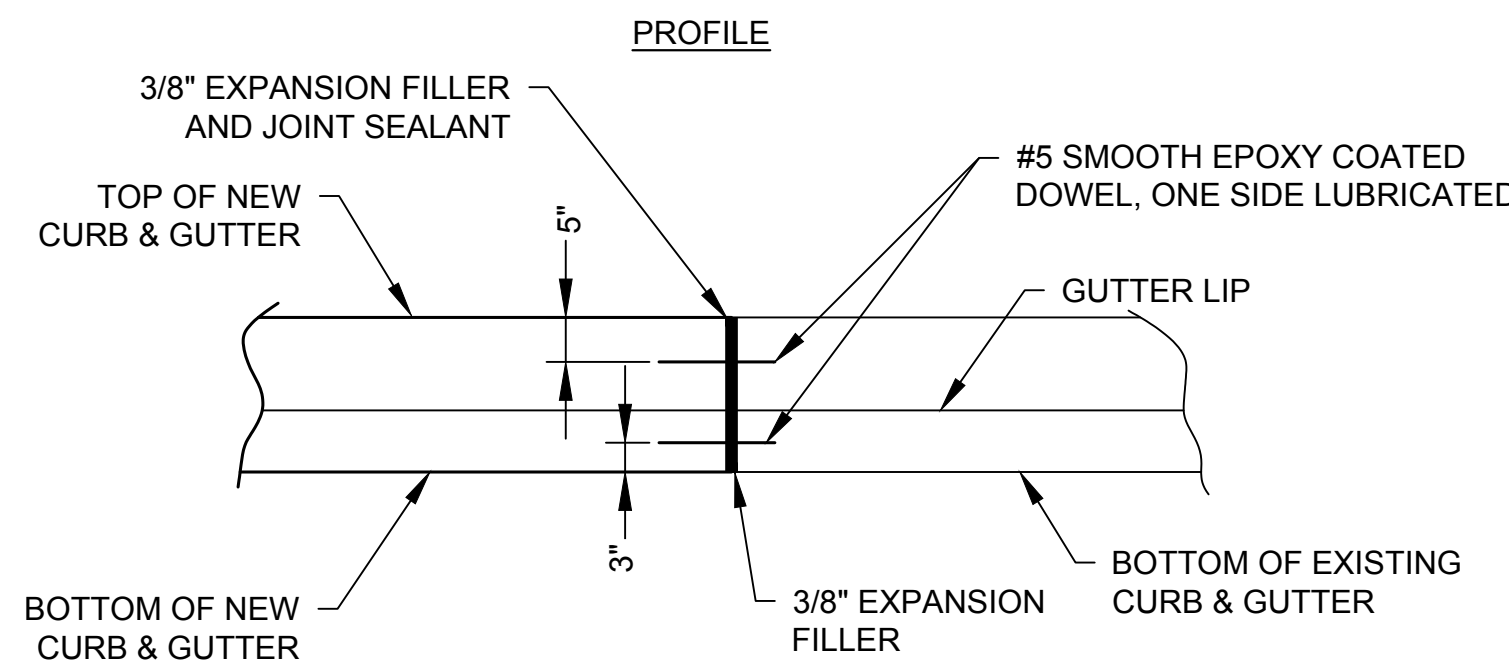
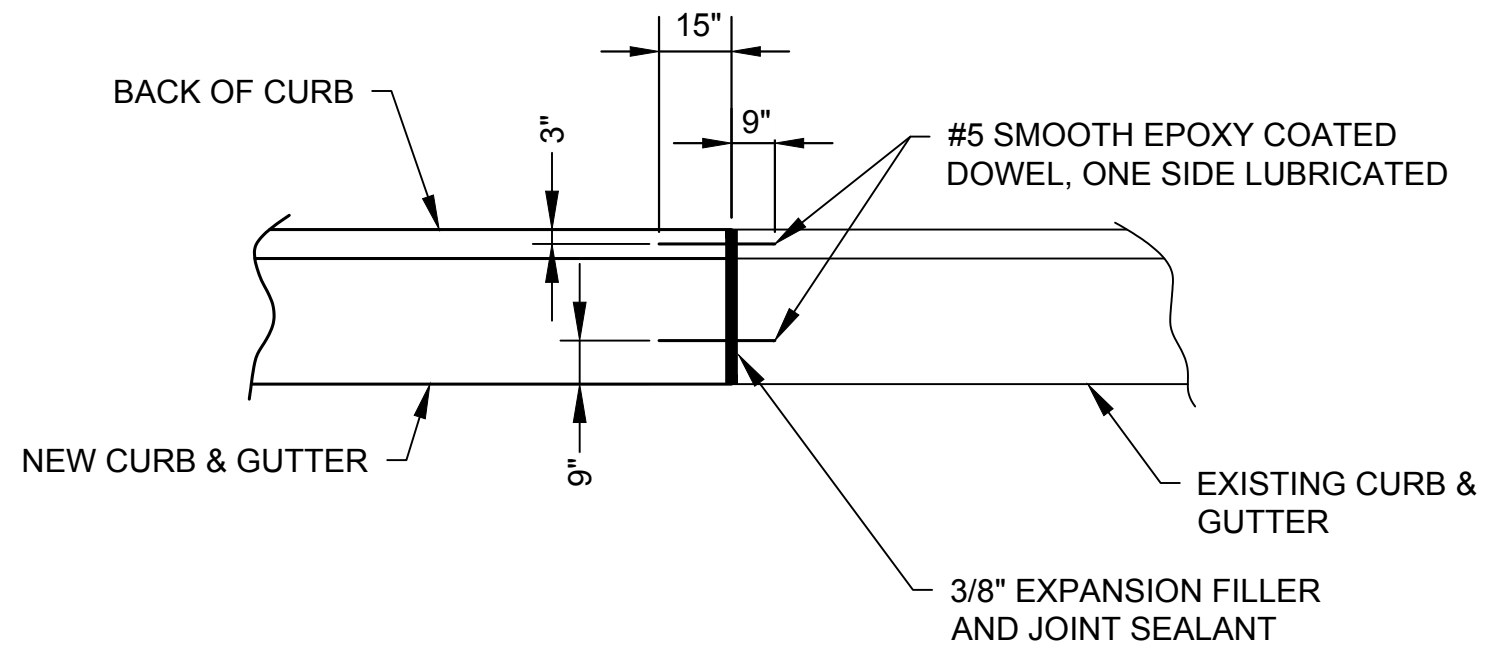

A4 CURB AND GUTTER ISOLATION JOINT  
C-500 N.T.S.

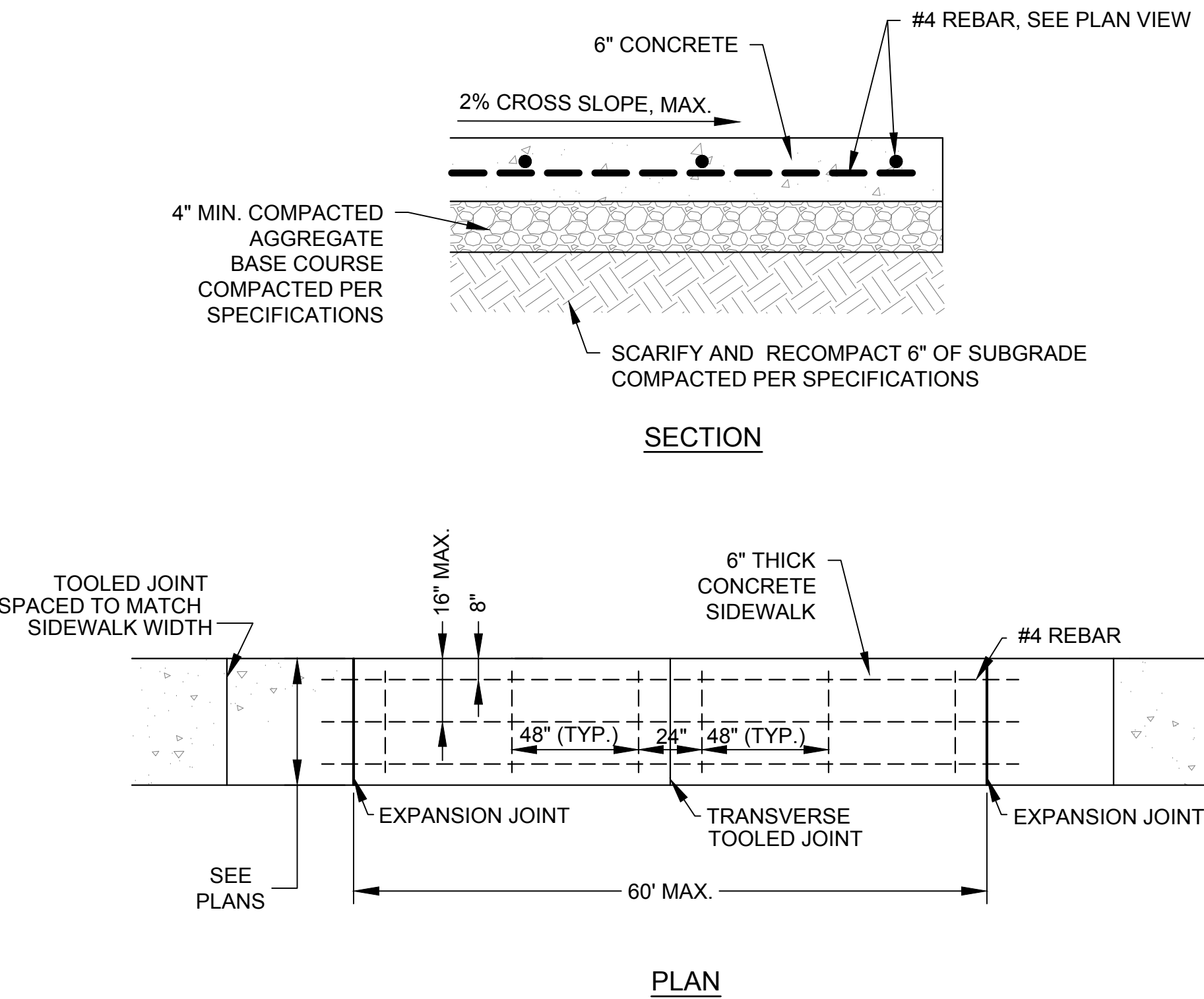

E1 6" REINFORCED SIDEWALK DETAIL  
C-500 N.T.S.

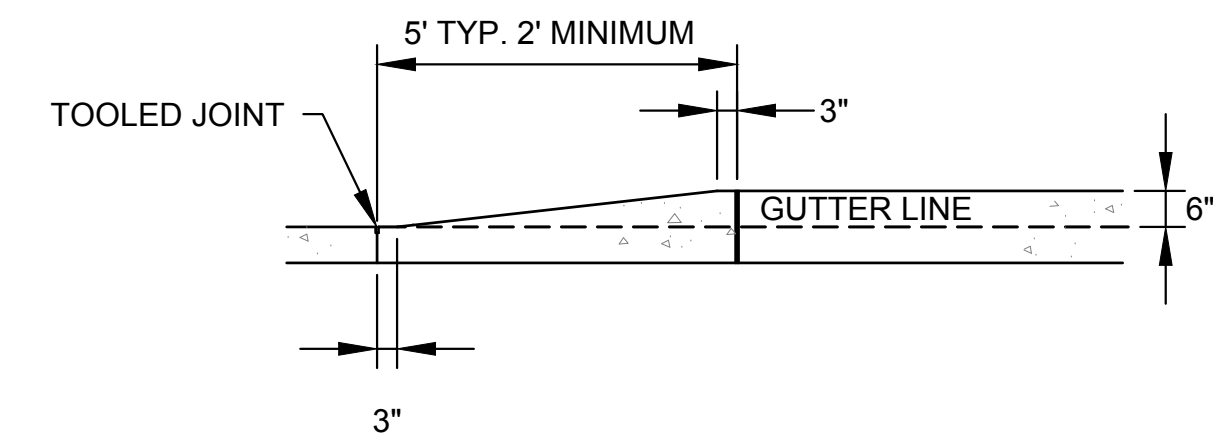

F1 CURB TAPER DETAIL  
C-500 N.T.S.

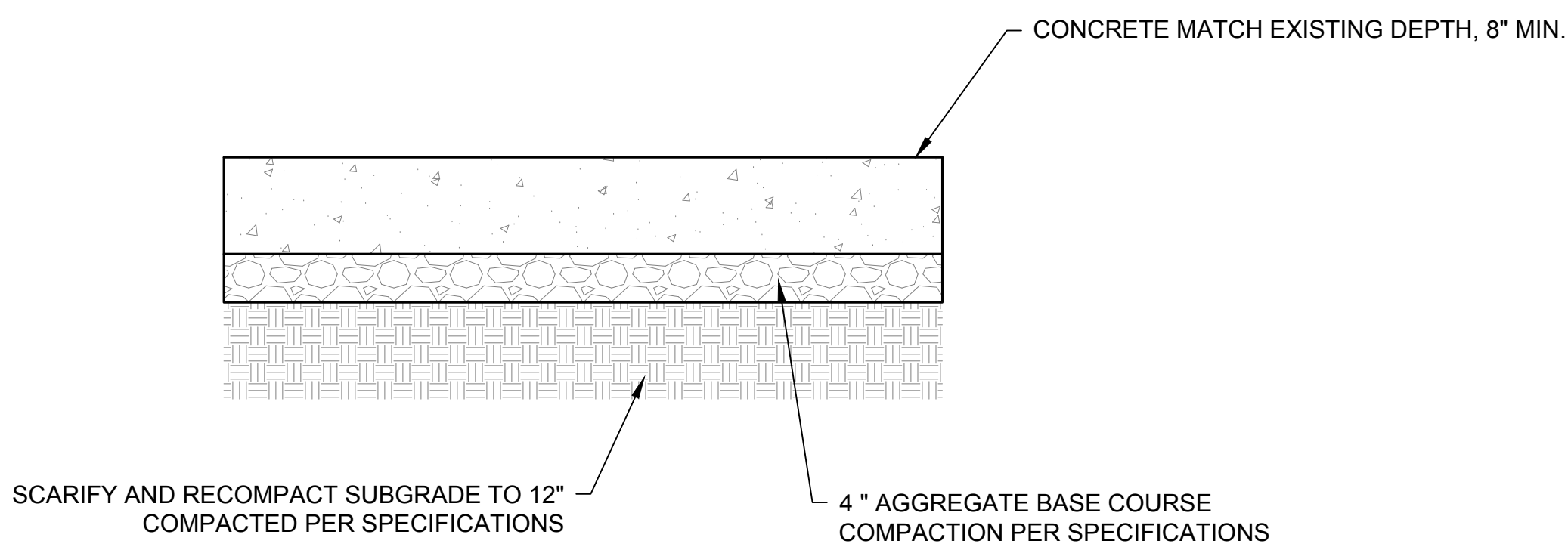

NOTE:  
IF ADJACENT EXISTING PAVEMENT HAS BASE COURSE, THEN PROVIDE BASE COURSE FOR NEW PAVEMENT TO MATCH EXISTING BASE COURSE THICKNESS. IF ADJACENT EXISTING PAVEMENT DOES NOT HAVE BASE COURSE, DO NOT USE BASE COURSE FOR NEW PAVEMENT.

A7 JOINTED PLAIN TYPICAL CONCRETE PAVEMENT SECTION  
C-500 N.T.S.

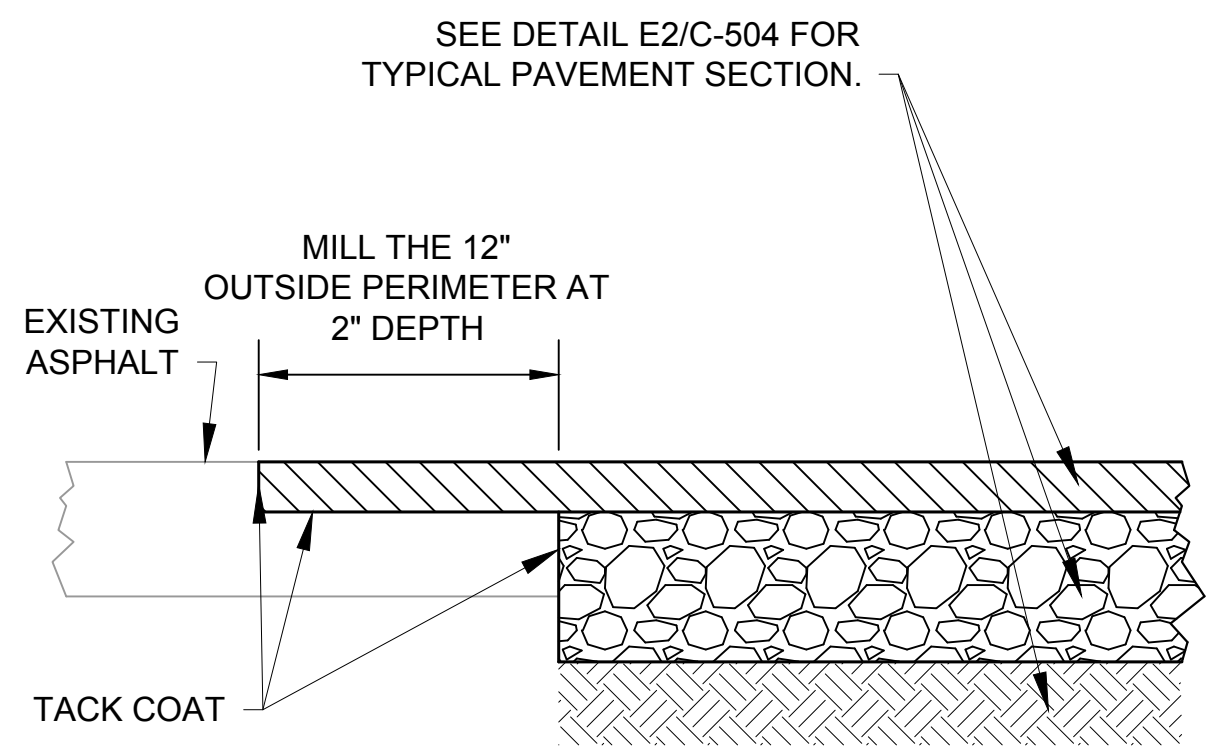

A8 ASPHALT ABUTMENT DETAIL  
C-500 N.T.S.

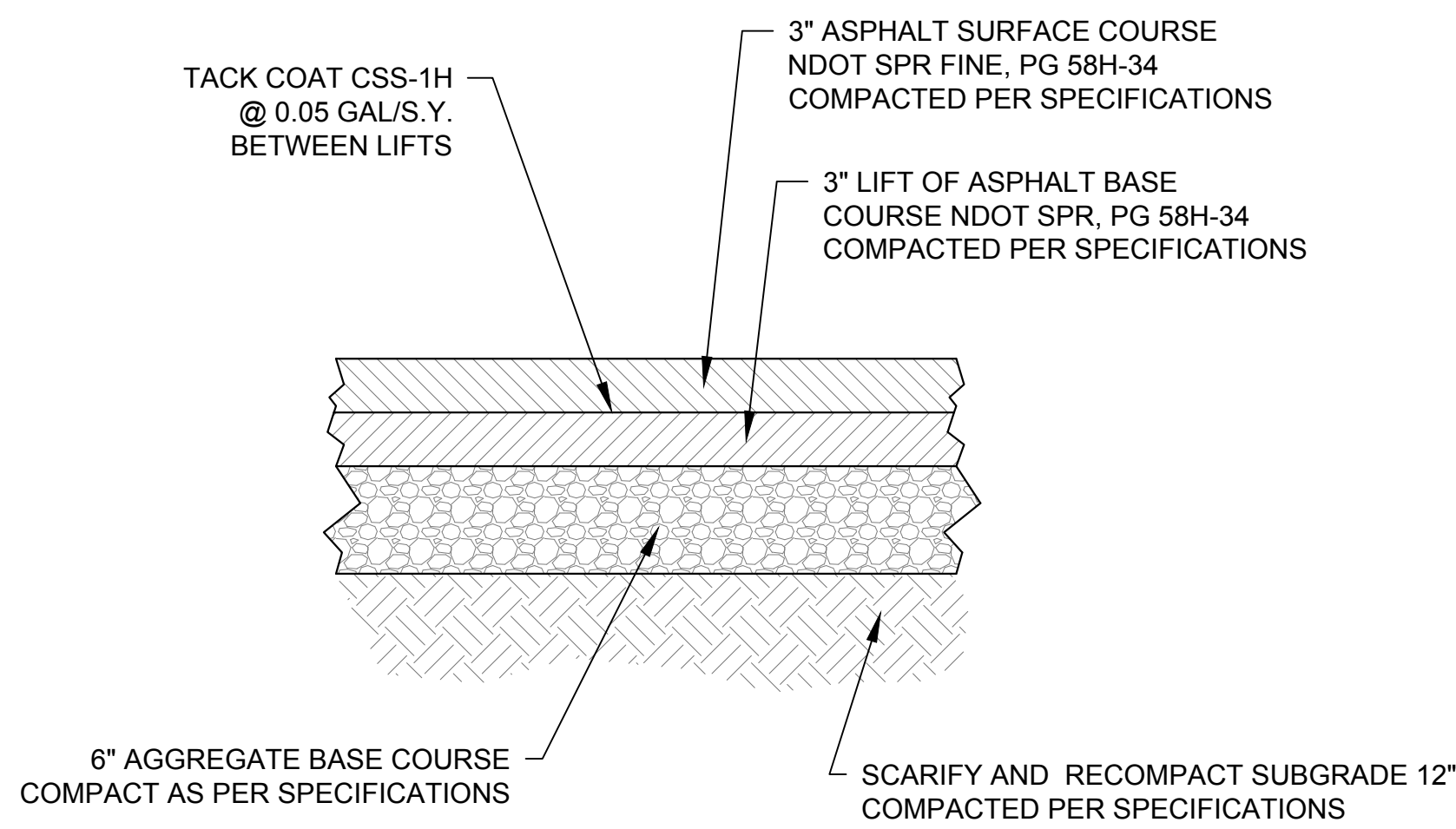

E4 ASPHALT PAVEMENT DETAIL  
C-500 N.T.S.

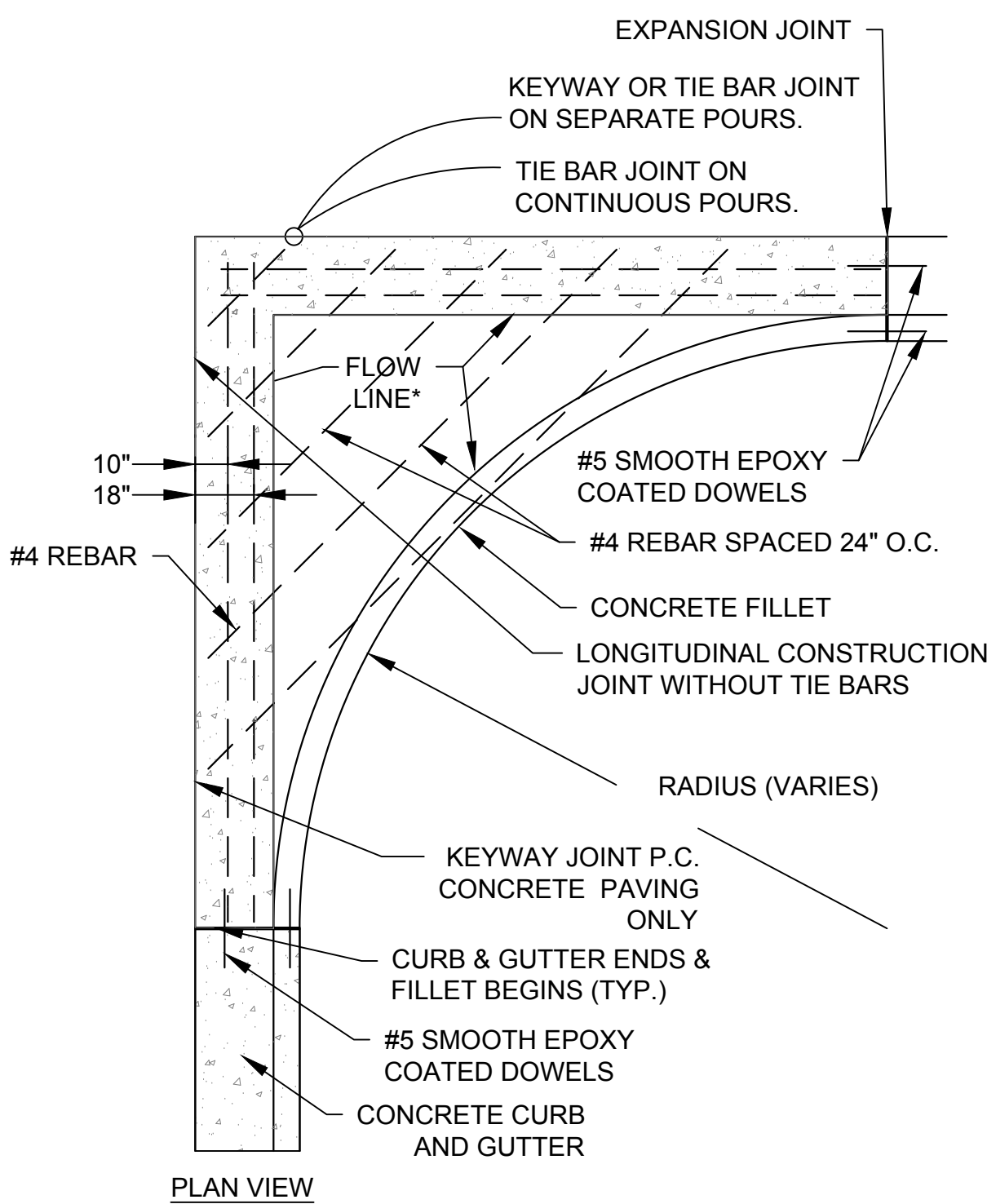

E6 REINFORCED PORTLAND CEMENT CONCRETE FILLET & PAN  
C-500 N.T.S.

NOTES:  
ALL REINFORCING BARS SHALL BE TIED AND CHAIRED, HAVE 2.0" CLEAR AND CONFORM TO ASTM A615 GRADE 60 EPOXY COATED STEEL.  
THE CONCRETE CURB SHALL BE MONOLITHIC WITH THE CONCRETE FILLET.  
SEE PLANS FOR FLOW LINE CONFIGURATION.

NOTES:  
ALL REINFORCEMENT STEEL SHALL BE EPOXY COATED, DEFORMED BAR.  
SEE PLANS FOR FLOW LINE CONFIGURATION.

## CONSTRUCTION DOCUMENTS

COMPLIANCE REVIEW INCLUDED	2/23/2024
Revisions:	Date

### CONSULTANTS:



TERRASITE DESIGN  
1635 DEADWOOD AVENUE  
RAPID CITY, SOUTH DAKOTA 57702  
PH: (605) 791-1736



ALBERTSON ENGINEERING, INC.  
315 NORTH MAIN AVENUE, SUITE 200  
SIOUX FALLS, SOUTH DAKOTA 57104  
PH: (605) 274-0880



FARRIS ENGINEERING  
12700 WEST DODGE ROAD  
OMAHA, NEBRASKA 68154  
PH: (402) 330-5900



### ARCHITECT

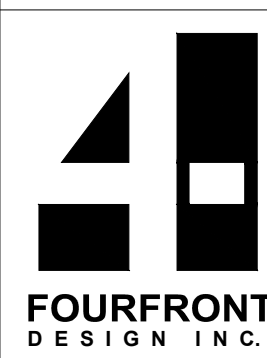

FOURFRONT DESIGN, INC.  
517 7TH STREET  
RAPID CITY, SOUTH DAKOTA  
57701  
PH: (605) 342-9470  
FAX: (605) 342-2377  
WWW.FOURFRONTDESIGN.COM

16.2330.A08

Drawing Title
CIVIL DETAILS #1
Approved: Project Director
Omaha VA Medical Center

Project Number	Building Number
16.2330.A08	25
Drawing Number	C-500
Dwg. 19 of 193	



Office of Construction and Facilities Management
Department of Veterans Affairs



8/2/2020 11:42:28 AM

three eighths inch = one foot  
one quarter inch = one foot  
one eighth inch = one foot  
one half inch = one foot  
three quarters inch = one foot  
one inch = one foot  
one and one half inches = one foot  
two inches = one foot  
three inches = one foot

COMPLIANCY REVIEW INCLUDED	2/23/2024
Revisions:	Date

CONSULTANTS:	
 TERRASITE DESIGN 1635 DEADWOOD AVENUE RAPID CITY, SOUTH DAKOTA 57702 PH: (605) 791-1736	 ALBERTSON ENGINEERING, INC. 315 NORTH MAIN AVENUE, SUITE 200 SIOUX FALLS, SOUTH DAKOTA 57104 PH: (605) 274-0880
 FARRIS ENGINEERING OMAHA [BRICK]   BENTLEY   COLUMBIAN SPRING 12700 WEST DODGE ROAD OMAHA, NEBRASKA 68154 PH: (402) 330-5900	

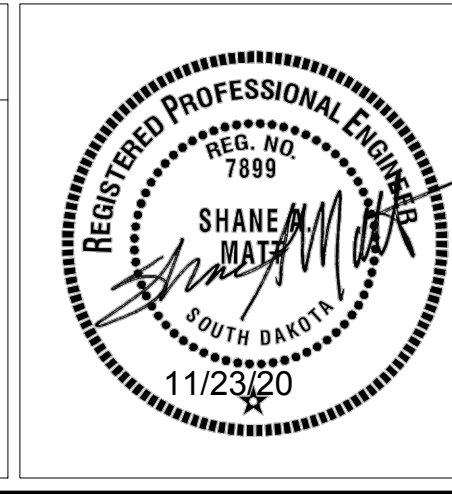

ARCHITECT	
 FOURFRONT DESIGN, INC. 517 7TH STREET RAPID CITY, SOUTH DAKOTA 57701 PH: (605) 342-9470 FAX: (605) 342-2377 WWW.FOURFRONTDESIGN.COM	16.2330.A08

Drawing Title	Project Title
CIVIL DETAILS #2	Design/Construct Sterile Processing Service- Omaha VA Medical Center
Approved: Project Director	Location
Omaha VA Medical Center	4101 Woolworth Ave #4199 Omaha, Ne 68105
	Date
	11/23/2020
	Checked
	SM
	Drawn
	JM

Project Number	Building Number
16.2330.A08	25
Drawing Number	
C-501	
Dwg. 20 of 193	



## CONSTRUCTION DOCUMENTS

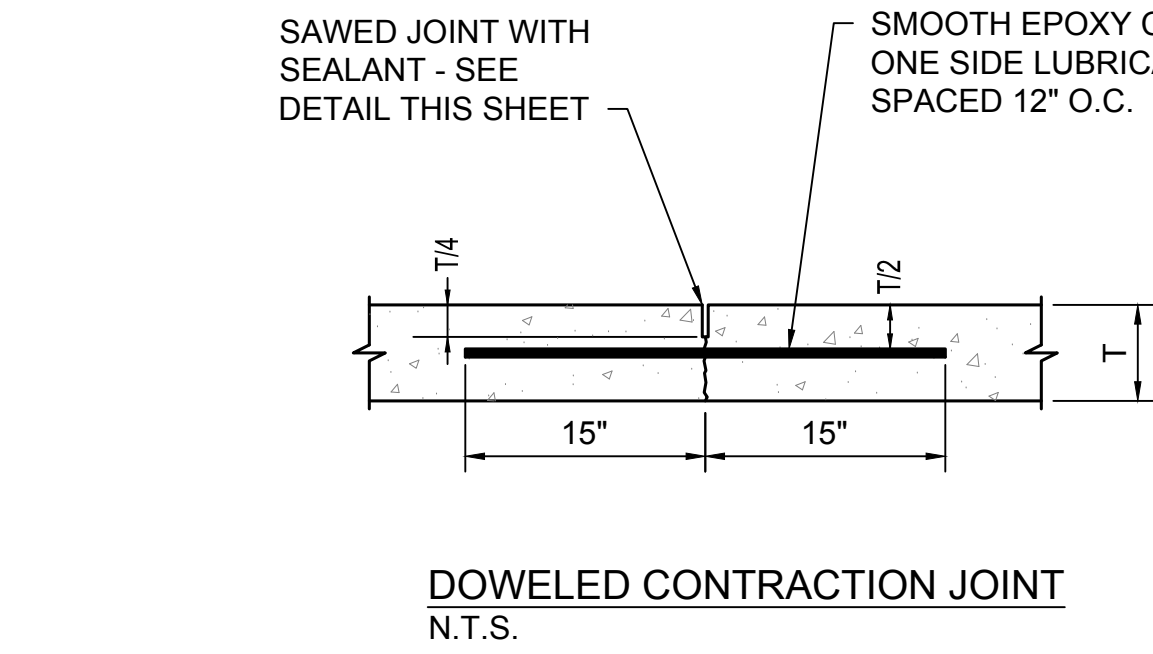

DOWELED CONTRACTION JOINT  
N.T.S.

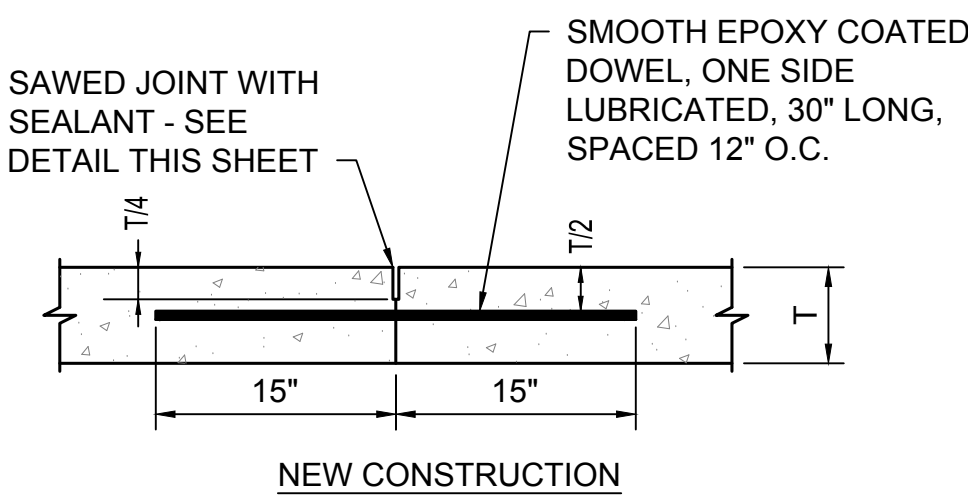

DOWELED CONSTRUCTION JOINT  
N.T.S.

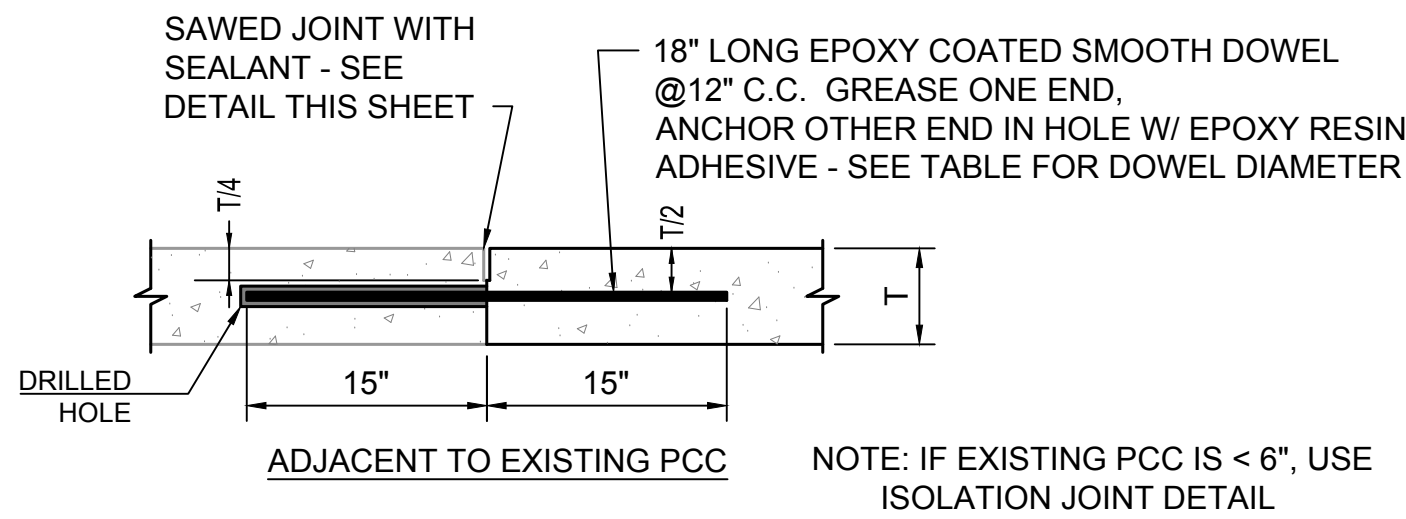

NOTE: IF EXISTING PCC IS < 6", USE ISOLATION JOINT DETAIL

- GENERAL NOTES:
- ALL WORK SHALL BE DONE IN ACCORDANCE WITH ACI 308R-08.
  - DOWEL BAR ASSEMBLY IS RECOMMENDED TO KEEP DOWELS IN PROPER ALIGNMENT.
  - DOWELS SHALL NOT BE PLACED CLOSER THAN 12" TO A JOINT INTERSECTION.

PAVEMENT THICKNESS (IN.)	DOWEL DIAMETER (IN.)
6	3/4"
7	1
>8	1 1/4

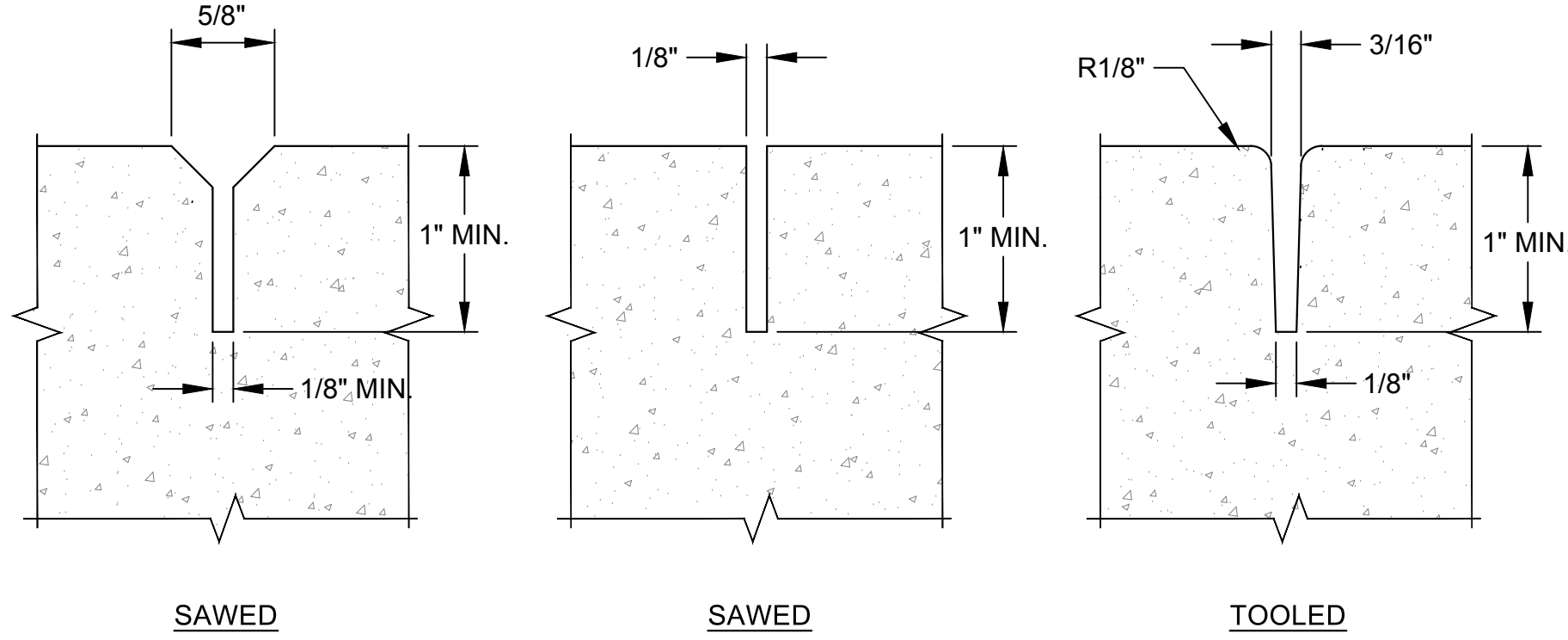

SIDEWALK CONTRACTION JOINT DETAILS  
N.T.S.

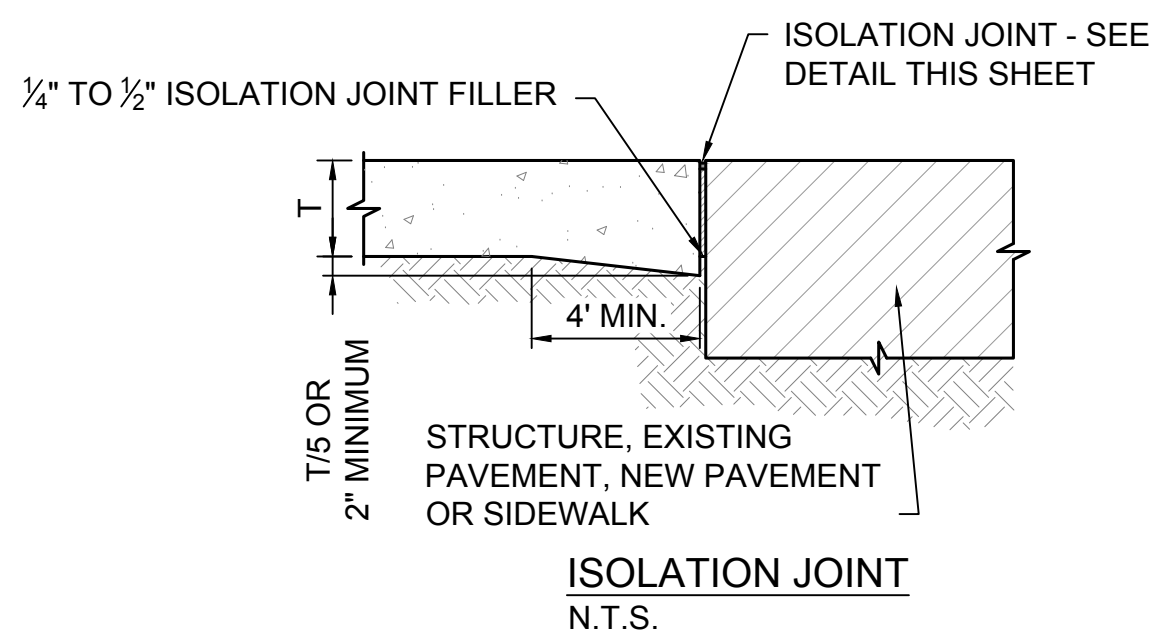

ISOLATION JOINT  
N.T.S.

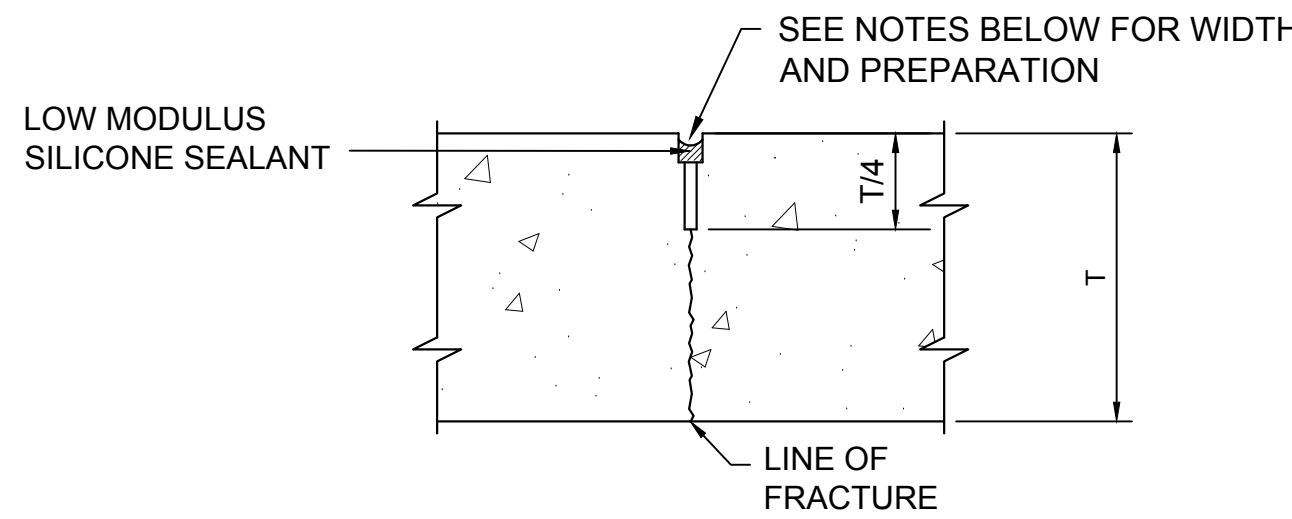

PAVEMENT CONTRACTION JOINT DETAILS  
N.T.S.

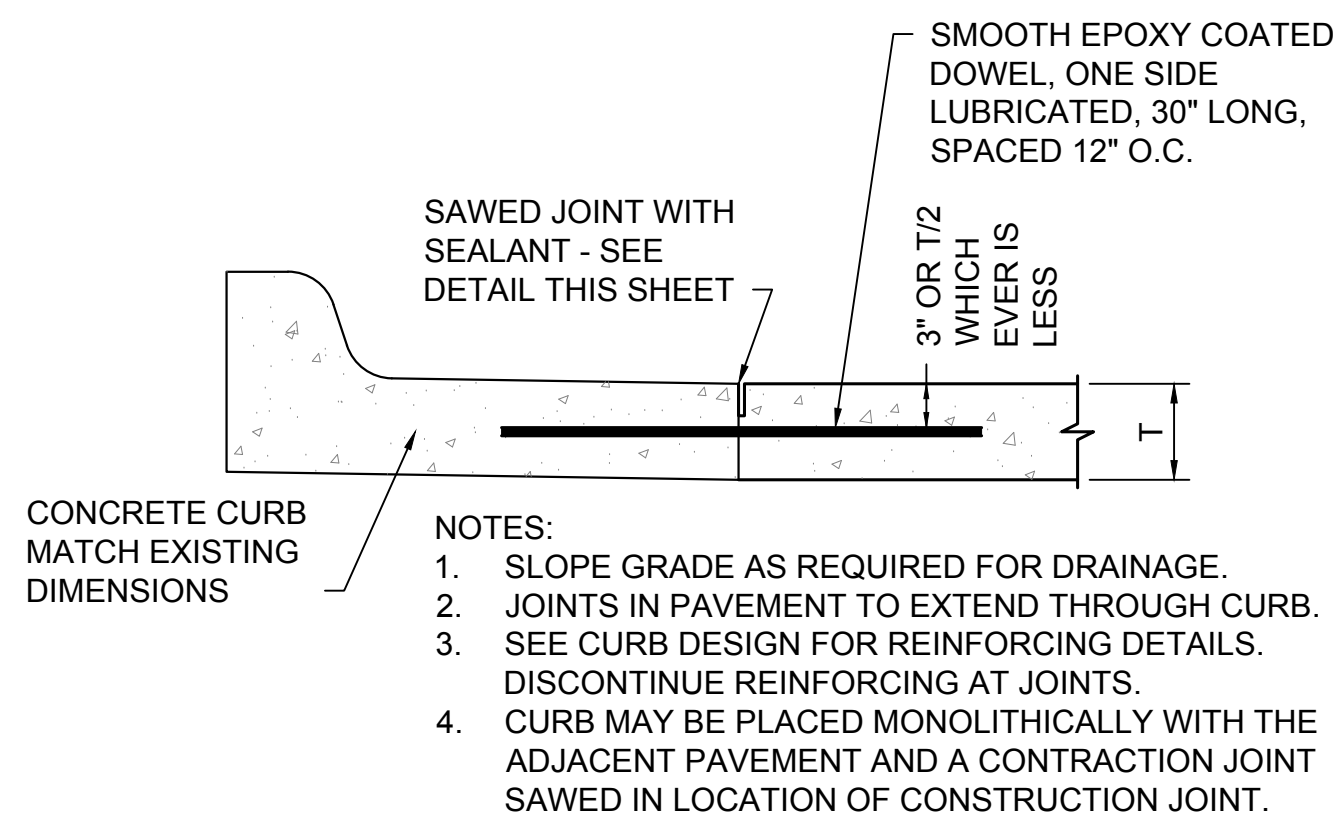

BUILDING ISOLATION JOINT  
N.T.S.

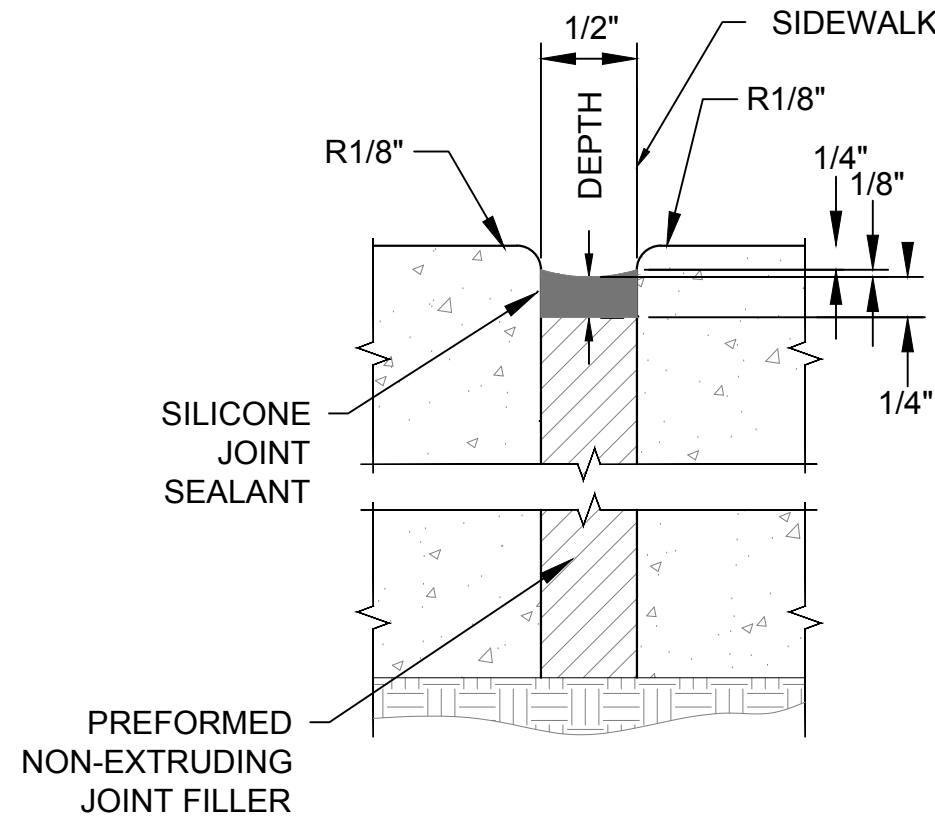

SIDEWALK OR PAVEMENT ISOLATION JOINT WITH SILICONE SEALANTS  
N.T.S.

SIDEWALK OR PAVEMENT ISOLATION JOINT DETAILS  
N.T.S.

F4 JOINT DETAILS  
C-501 N.T.S.



